

# **RISEN**<sup>®</sup>

## AIR/OIL HEAT EXCHANGER



Guangzhou Risen Machinery Co., Ltd (stock code:890552) was established in 2002, a modern high-tech enterprise specializing in hydraulic oil cylinder , air/oil heat exchanger and auto radiator . Now our company has more than 200 employees , a plant of more than 6,000 quare meters which includes 5 independent workshops , business office and exhibition hall of more than 800 square meters . A new production base of 50,000 square meters in the new industry city of Northern Guangdong is under building , which is the first batch of settle-in enterprises , planning to put into production formally in 2015. We strictly conduct R&D and manufacture in accordance with industry norms and have already passed the ISO9001:2008 quality certificate . Our products have been exported to Asia , Australia , Europe etc and our brand “RISEN” has received many compliments from clients home and abroad.



Risen's hydraulic oil cooler products can be applied on the cooling system of oil draining and oil returning , with various installation ways . We are able to produce types of standard and customized heat exchangers , oilcoolers , condensers , radiators and so on . By using high quality Aluminum material of light weighted , anti-vibration and high heat exchange efficiency , as well as the plate-fin structure to increase the heat exchange area and accelerate the thermal conductivity , our products perfectly achieve the cooling effect based on low cost and high efficiency.



# BNT HONOR

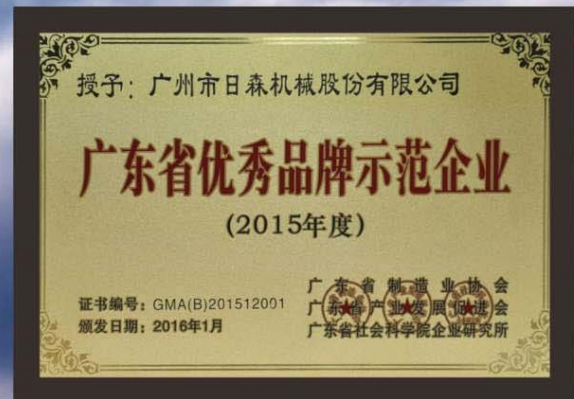

# 20 *years of continuous exploration and innovation*

**1992**

The founder of the enterprise starts with the sales of hydraulic products

**July 2002**

Establishment GuangZhou City, Risen Machinery Co., with research and development, design, production and sale of fuel tanks and hydraulic products.

**December 2009**

Creation of new radiator production plant to produce various types of air cooler

**March 2010**

Risen radiator products has began to enter the international market, with exports to the Middle East, Russia, Africa, Australia and other countries

**May 2014**

Risen Machinery has listed in the Guangzhou equity trading centre, with equity Code: 890552

**October 2014**

Establishment of Yingde City, Risen Machinery Co., Ltd.

**July 2015**

Establishment of the shareholding system reform, and officially changed its name to Guangzhou City, Risen Machinery Co., Ltd.

**2016**

Planning to trade on the new OTC(over-the-counter) market

**We have been trying**

Continuous technological innovation



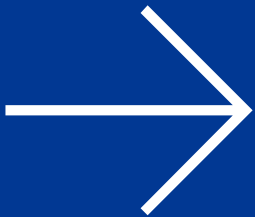

# Enterprise Culture

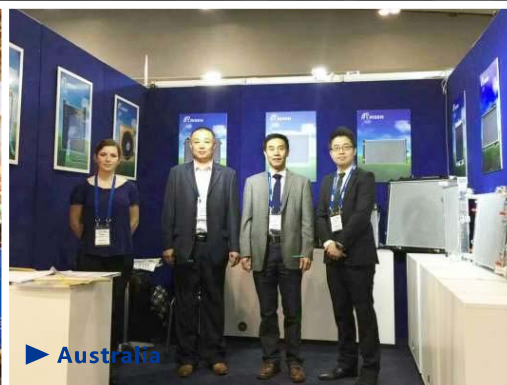

# CATALOG

AF0510T-CA.....	P1	ECO-04.....	P25
AF1025T-CA.....	P2	ECO-07.....	P26
AL404T-CA.....	P3	FR-02.....	P27
AL608T-CA.....	P4	FR-03.....	P28
AL609T-CA.....	P5	FR-04.....	P29
AW0607T-CA.....	P6	FR-05.....	P30
AH0607T-CA.....	P7	LOC-004.....	P31
AH0608T-CA.....	P8	LOC-007.....	P32
AH0608TL-CA.....	P9	LOC-011.....	P33
AH0609T-CA.....	P10	LOC-016.....	P34
AH1012T-CA.....	P11	LOC-023.....	P35
AH/AJ1012T-DC.....	P12	LOC-033.....	P36
AH1417T-CA.....	P13	LOC2-033.....	P37
AH/AJ1417T-DC.....	P14	AH2431T-CA-B.....	P38
AH1470T-CA.....	P15	AJ0510-CA.....	P39
AH/AJ1470T-DC.....	P16	AJ0608-CA.....	P40
AH1490T-CA.....	P17	AJ1025-CA.....	P41
AH/AJ1490T-DC.....	P18	AH1012T1-CA.....	P42
AH1680T-CA.....	P19	AJ1012T1-CA.....	P43
AH2431T-CA.....	P20	RSOL series water coolers.....	P44
AH3818T-CA.....	P21	RSALA Series.....	P46
AH3-2583T-CA.....	P22	Cooler For Concrete Mixers.....	P48
AH1890T-CA.....	P23	OEM Service Provided.....	P49
SQ1015T-CA.....	P24		

Specifications and design characteristics may be change without prior notice.

## AF Series Plate-Fin Hydraulic Aluminum Oil Coolers

### Specifications

**AF0510T-CA-10L**



Model	AF0510T-CA	Cooling Capacity	1.2KW
Rate of flow	10L/min	Weight	2KG
Working pressure	≤1.0MPa	Packing size	27*23.5*15CM
Fan power	34W	Fan voltage	AC110V/AC220V-240V/AC380V/ DC12V/DC24V/50HZ
Exterior cooling area	0.8M <sup>2</sup>	Special voltage & size can be customized	

### Dimensions

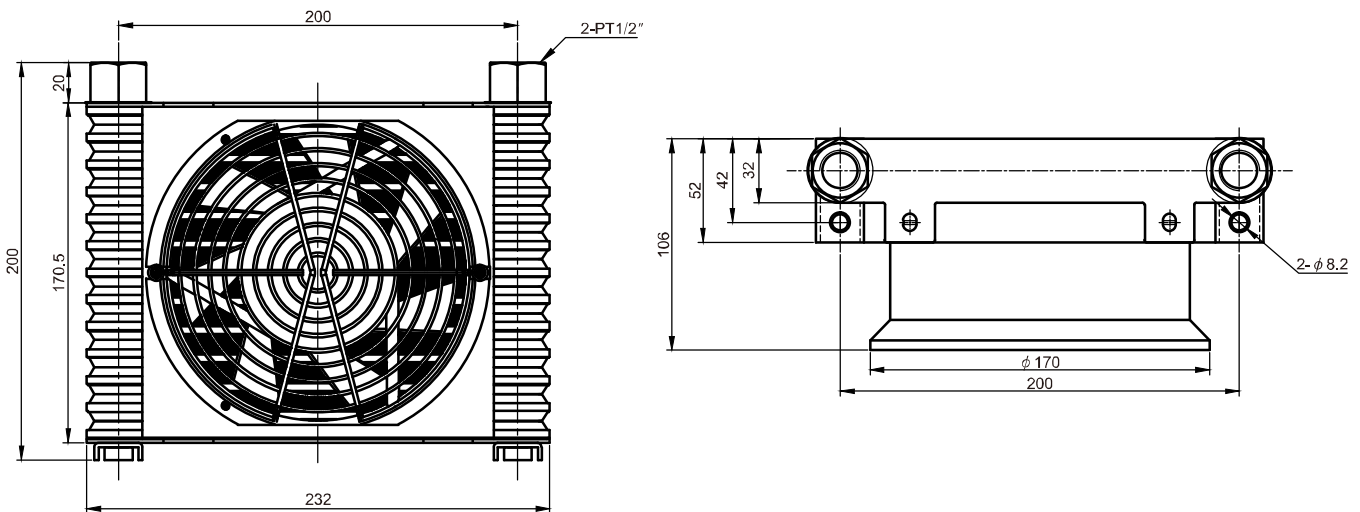

### Performance Curves

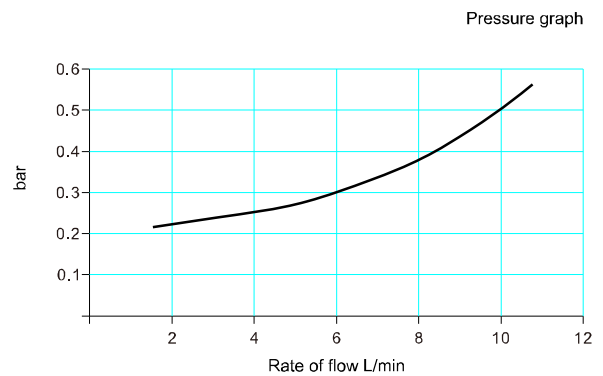
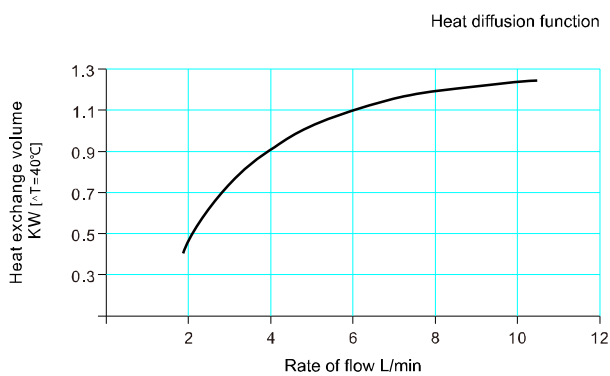



## AF Series Plate-Fin Hydraulic Aluminum Oil Coolers

### Specifications

**AF1025T-CA-25L**

Model	AF1025T-CA	Cooling Capacity	1.35KW
Rate of flow	25L/min	Weight	3KG
Working pressure	≤1.0MPa	Packing size	29*29*15CM
Fan power	34W	Fan voltage	AC110V/AC220V-240V/AC380V/ DC12V/DC24V/50HZ
Exterior cooling area	1.3M <sup>2</sup>	Special voltage & size can be customized	



### Dimensions

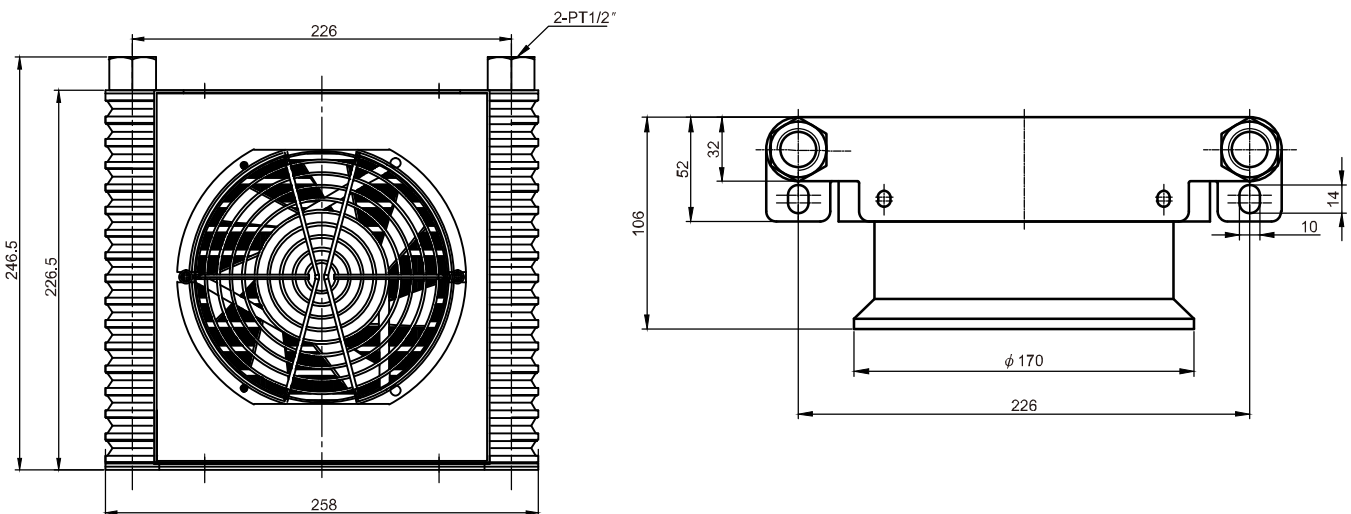

### Performance Curves

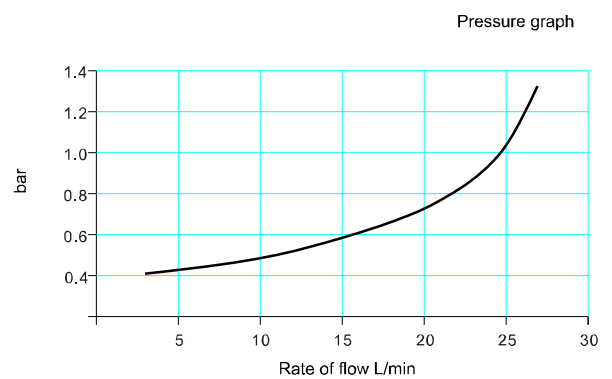
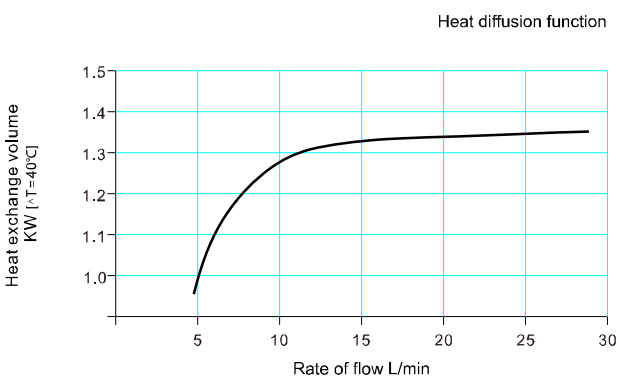

## AL Series Plate-Fin Hydraulic Aluminum Oil Coolers

### Specifications

### AL404T-CA-10L



Model	AL404T-CA	Cooling Capacity	1.2KW
Rate of flow	10L/min	Weight	2.5KG
Working pressure	≤1.0MPa	Packing size	29*24*15CM
Fan power	34W	Fan voltage	AC110V/AC220V-240V/AC380V/ DC12V/DC24V/50HZ
Exterior cooling area	1.2M <sup>2</sup>	Special voltage & size can be customized	

### Dimensions

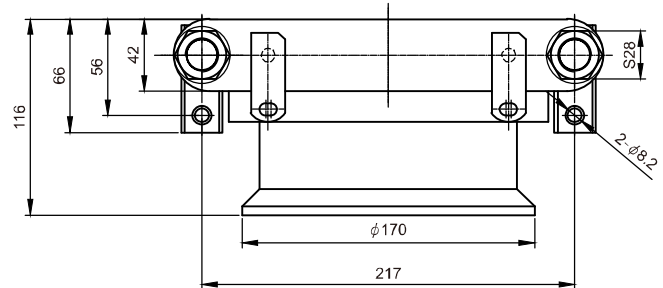
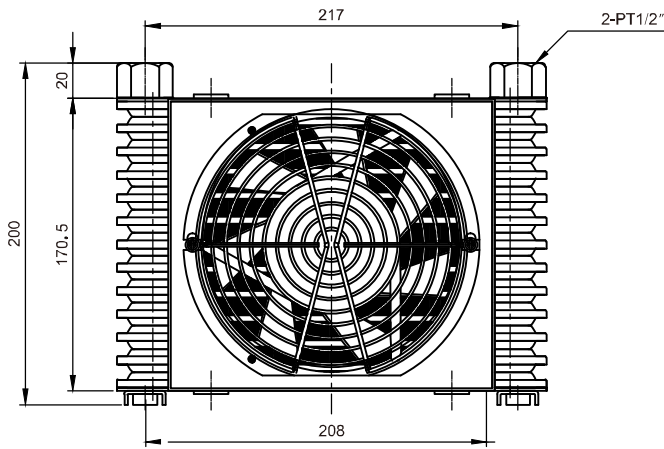

### Performance Curves

Heat diffusion function

Pressure graph

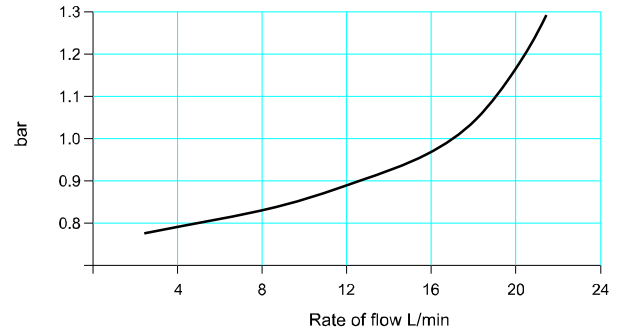
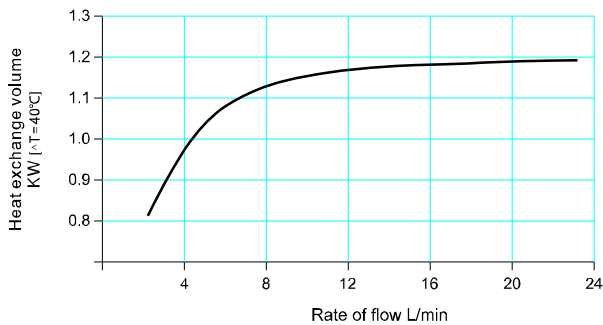

## AL Series Plate-Fin Hydraulic Aluminum Oil Coolers

### Specifications

**AL608T-CA-10L**

Model	AL608T-CA	Cooling Capacity	0.8KW
Rate of flow	10L/min	Weight	2.4KG
Working pressure	≤1.0MPa	Packing size	29*24*15CM
Fan power	34W	Fan voltage	AC110V/AC220V-240V/AC380V/ DC12V/DC24V/50HZ
Exterior cooling area	0.9M <sup>2</sup>	Special voltage & size can be customized	



### Dimensions

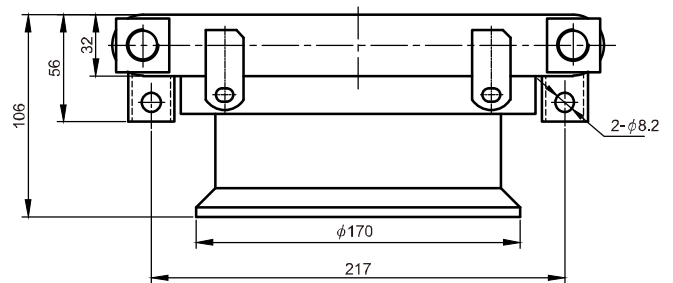
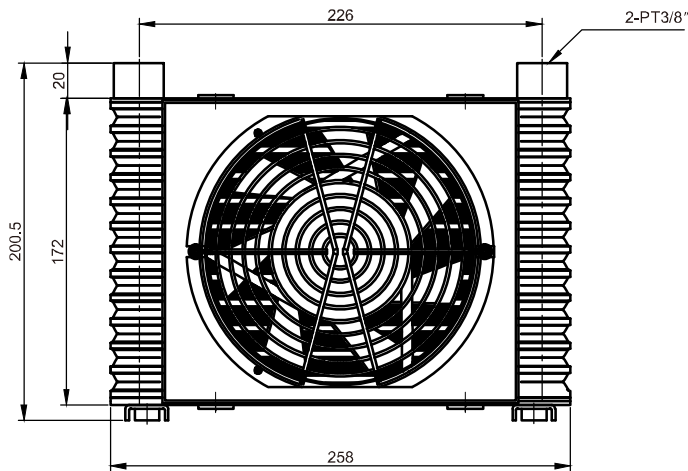

### Performance Curves

Heat diffusion function

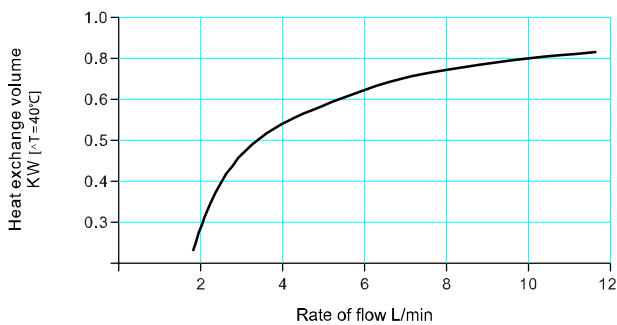

Pressure graph

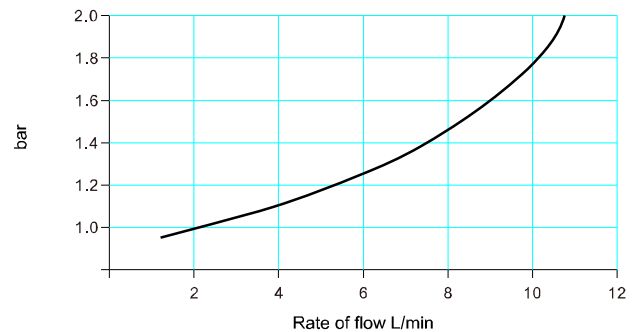

## AL Series Plate-Fin Hydraulic Aluminum Oil Coolers

### Specifications

**AL609T-CA-10L**

Model	AL609T-CA	Cooling Capacity	0.8KW
Rate of flow	10L/min	Weight	2.3KG
Working pressure	≤1.0MPa	Packing size	29*24*15CM
Fan power	34W	Fan voltage	AC110V/AC220V-240V/AC380V/ DC12V/DC24V/50HZ
Exterior cooling area	0.8M <sup>2</sup>	Special voltage & size can be customized	



### Dimensions

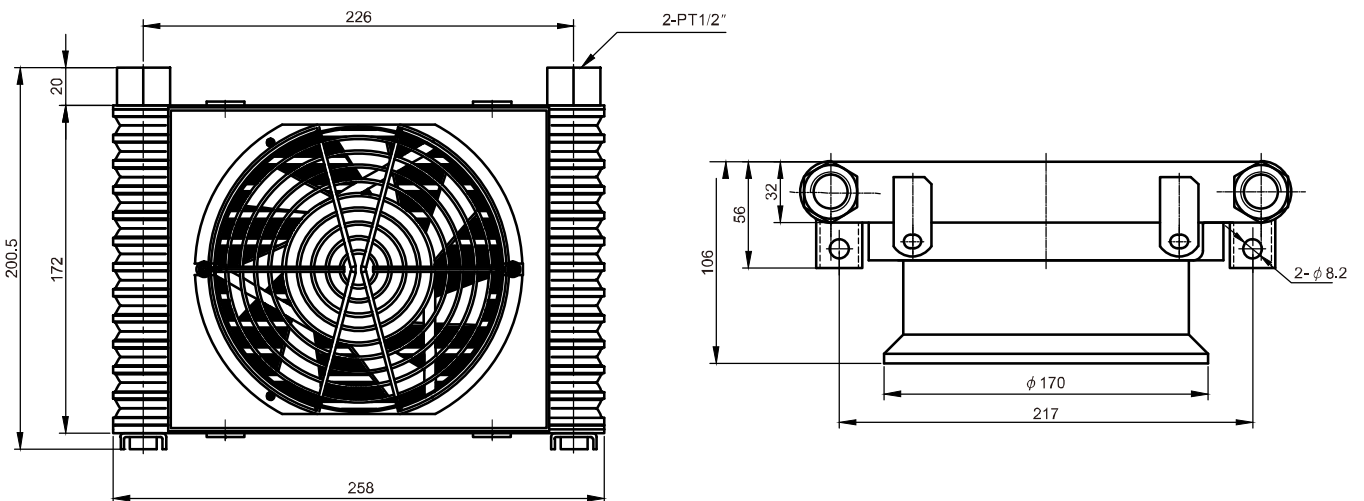

### Performance Curves

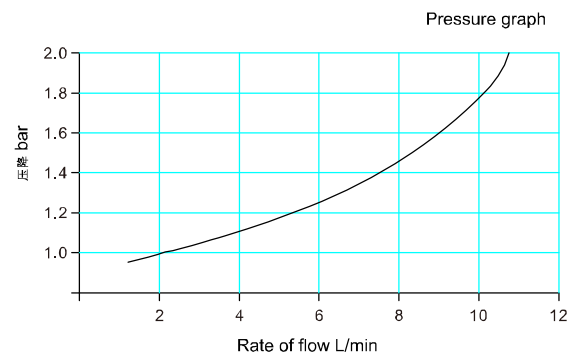
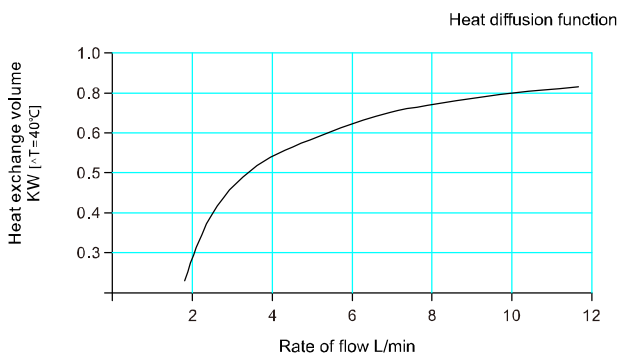

## AW Series Plate-Fin Hydraulic Aluminum Oil Coolers

### Specifications

### AW0607T-CA-20L



Model	AW0607T-CA	Cooling Capacity	1.1KW
Rate of flow	20L/min	Weight	4KG
Working pressure	≤2MPa	Packing size	28*21.5*13CM
Fan power	34W	Fan voltage	AC110V/AC220V-240V/AC380V/ DC12V/DC24V/50HZ
Exterior cooling area	0.8M <sup>2</sup>	Special voltage & size can be customized	

### Dimensions

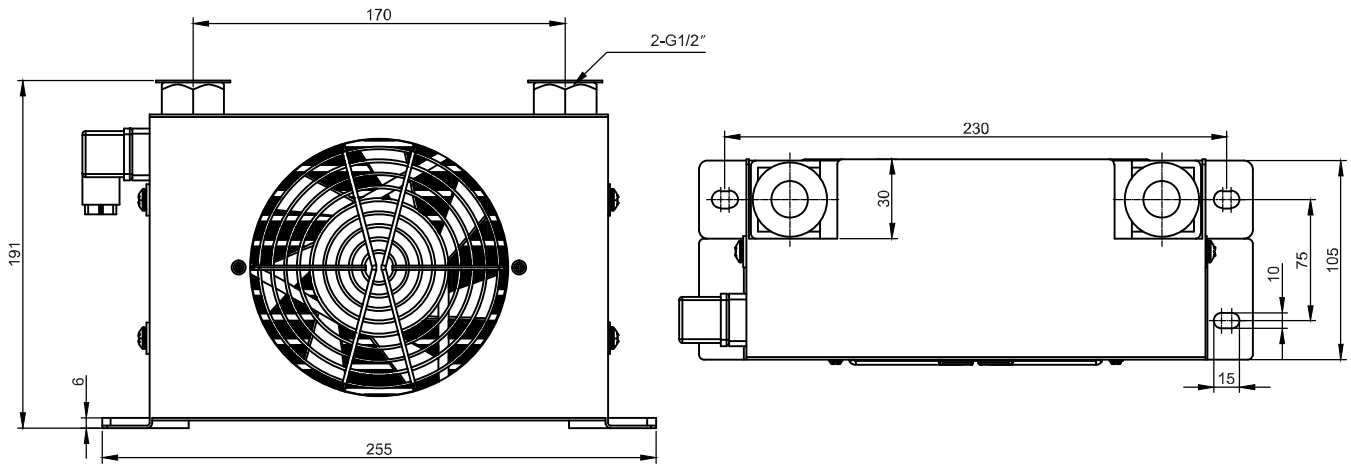

### Performance Curves

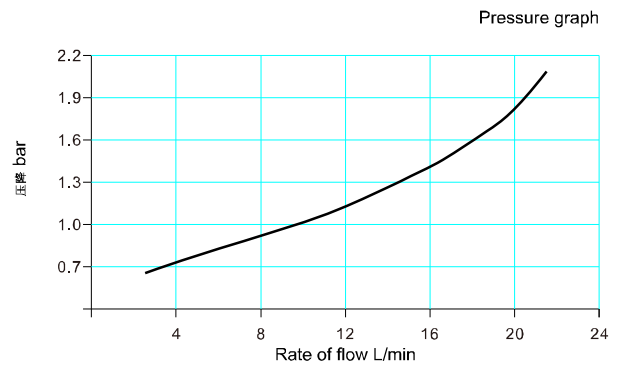
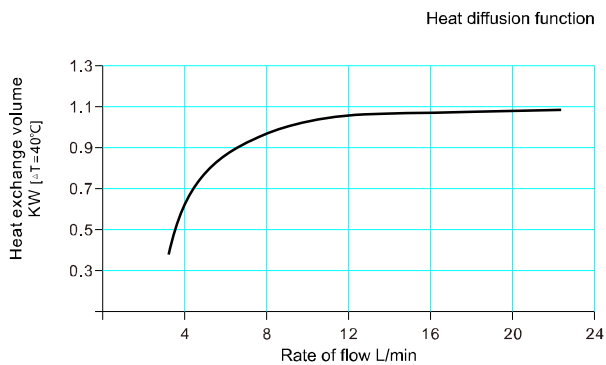

## AH Series Plate-Fin Hydraulic Aluminum Oil Coolers

### Specifications

**AH0607T-CA-40L**



Model	AH0607T-CA	Cooling Capacity	1.05KW
Rate of flow	40L/min	Weight	5KG
Working pressure	≤2MPa	Packing size	28*21.5*13CM
Fan power	34W	Fan voltage	AC110V/AC220V-240V/AC380V/ DC12V/DC24V/50HZ
Exterior cooling area	1M <sup>2</sup>	Special voltage & size can be customized	

### Dimensions

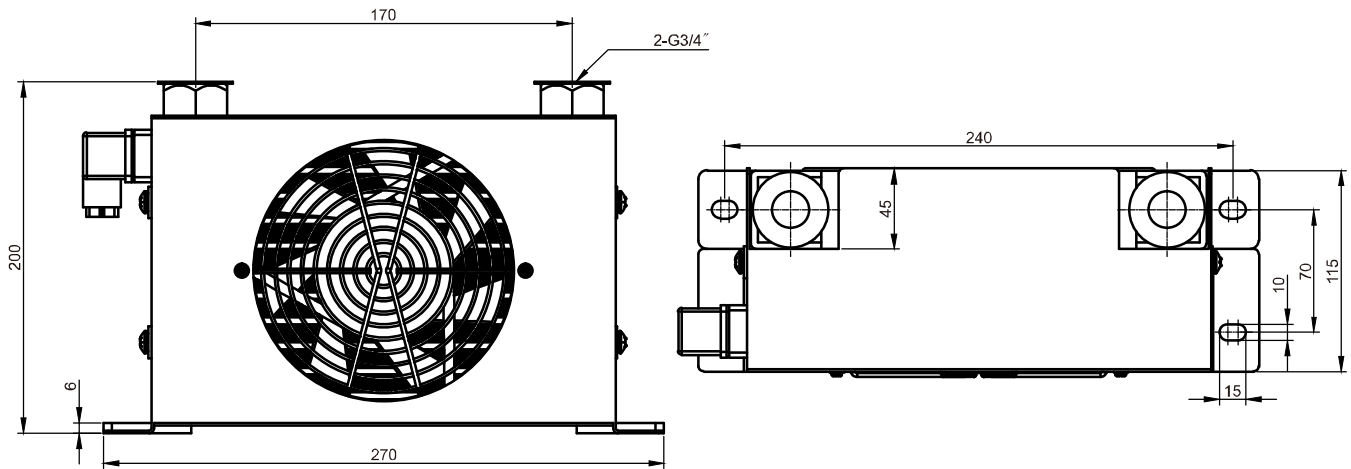

### Performance Curves

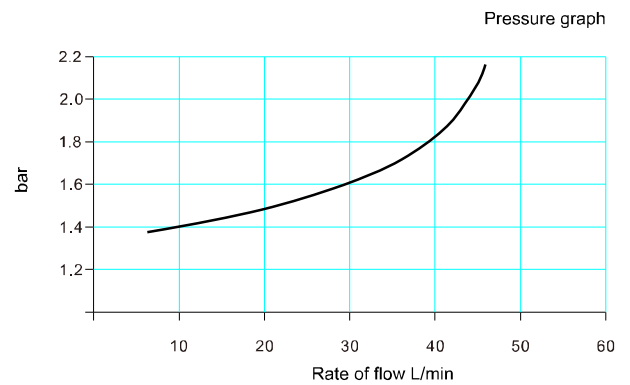
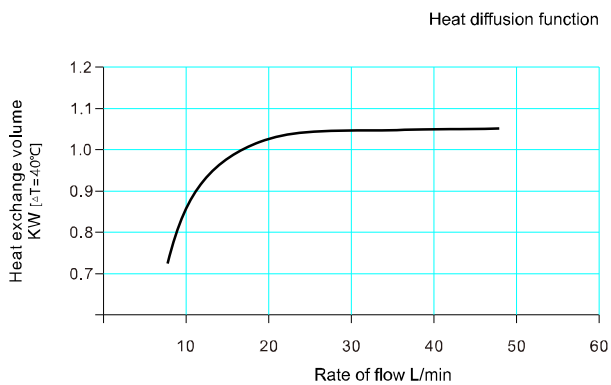

## AH Series Plate-Fin Hydraulic Aluminum Oil Coolers

### Specifications

**AH0608T-CA-60L**

Model	AH0608T-CA	Cooling Capacity	1.8KW
Rate of flow	60L/min	Weight	6KG
Working pressure	≤2MPa	Packing size	35*22.5*14CM
Fan power	34W	Fan voltage	AC110V/AC220V-240V/AC380V/ DC12V/DC24V/50HZ
Exterior cooling area	1.3M <sup>2</sup>	Special voltage & size can be customized	



### Dimensions

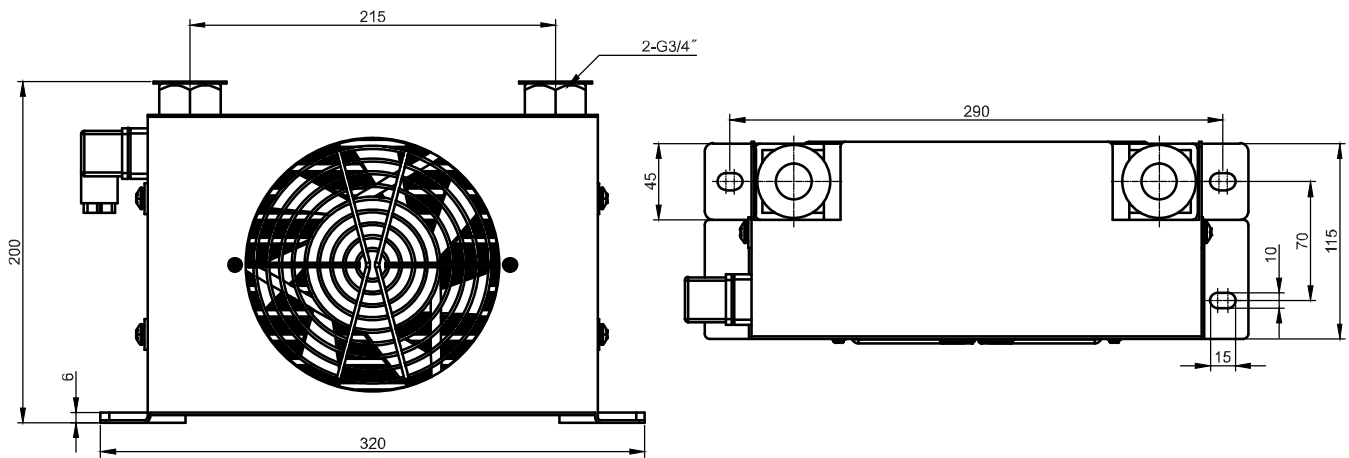

### Performance Curves

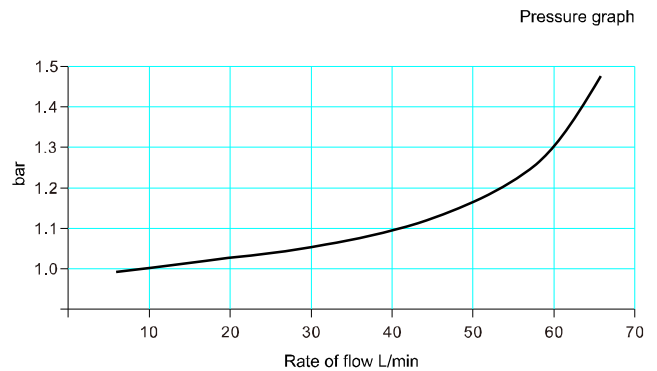
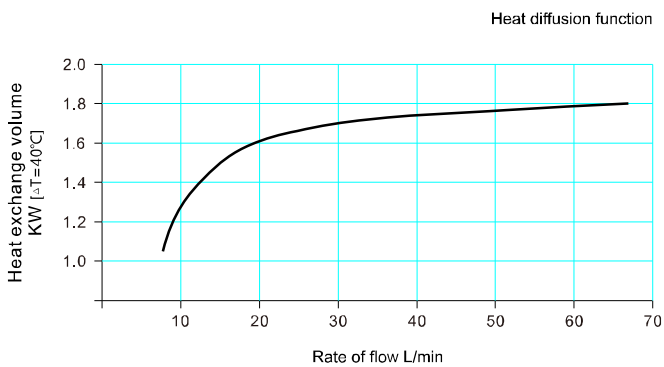

## AH Series Plate-Fin Hydraulic Aluminum Oil Coolers

### Specifications

### AH0608TL-CA-60L



Model	AH0608TL-CA	Cooling Capacity	2.4KW
Rate of flow	60L/min	Weight	7KG
Working pressure	≤2MPa	Packing size	44*22*15.5CM
Fan power	2*34W	Fan voltage	AC110V/AC220V-240V/AC380V/ DC12V/DC24V/50HZ
Exterior cooling area	1.8M <sup>2</sup>	Special voltage & size can be customized	

### Dimensions

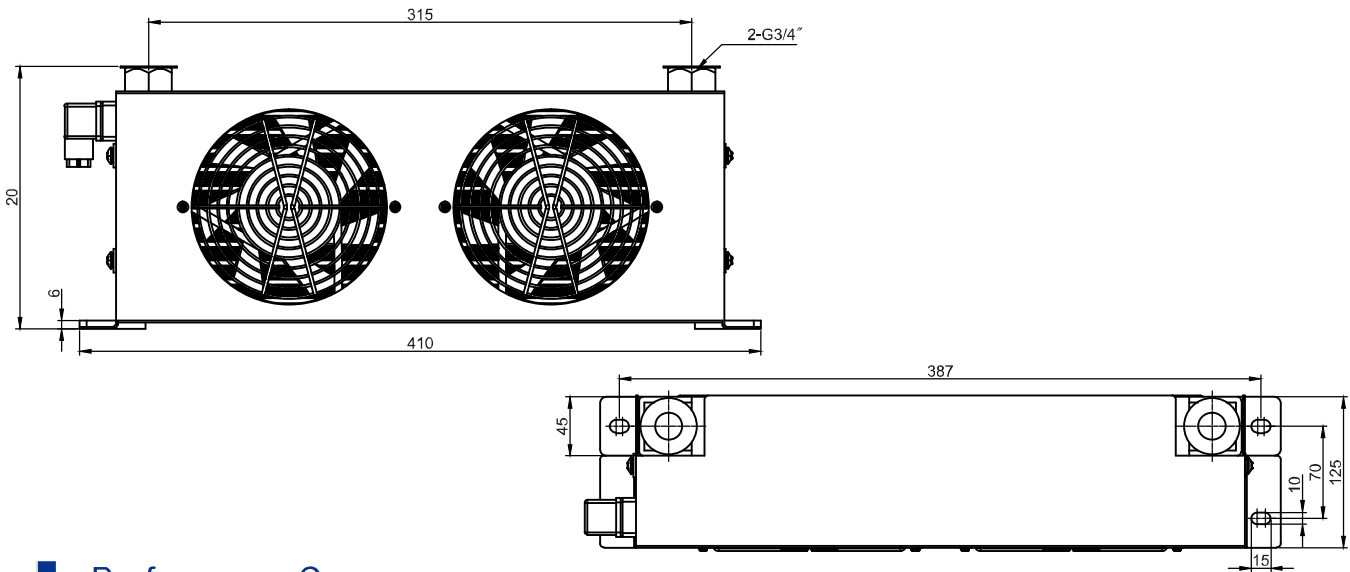

### Performance Curves

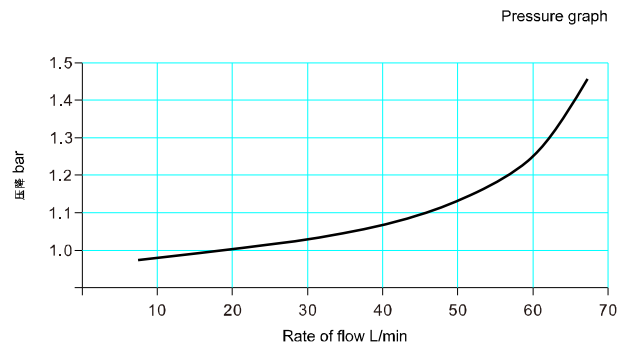
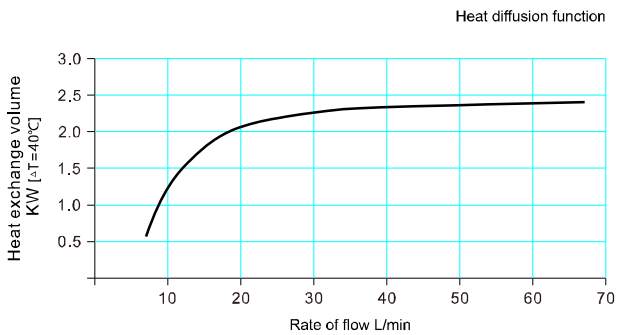



## AH Series Plate-Fin Hydraulic Aluminum Oil Coolers

### Specifications

AH0609T-CA-90L

Model	AH0609T-CA	Cooling Capacity	5KW
Rate of flow	90L/min	Weight	11KG
Working pressure	≤2MPa	Packing size	50*43*22CM
Fan power	34W	Fan voltage	AC110V/AC220V-240V/AC380V/ DC12V/DC24V/50HZ
Exterior cooling area	3.1M <sup>2</sup>	Special voltage & size can be customized	



### Dimensions

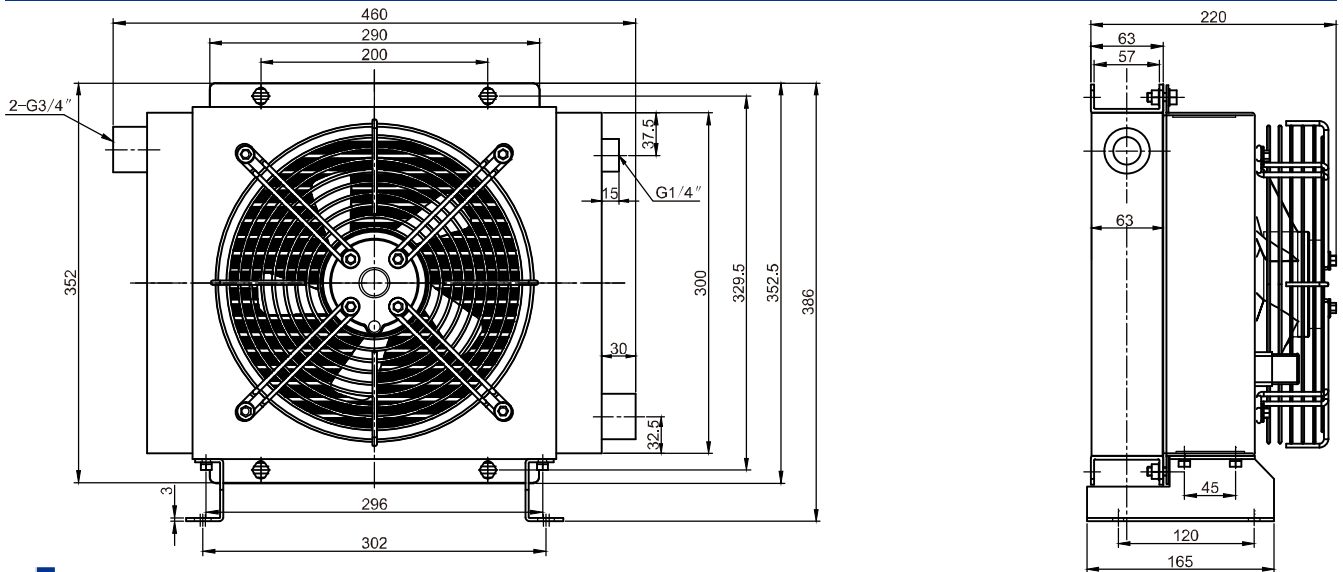

### Performance Curves

Heat diffusion function

Pressure graph

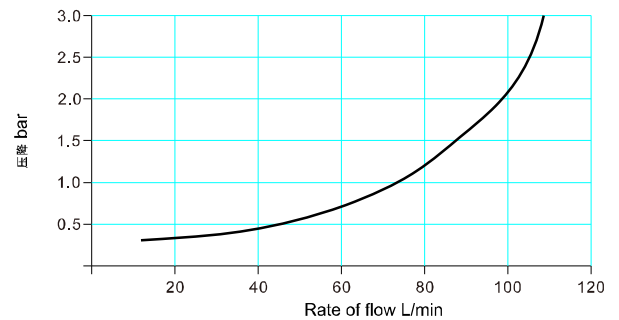
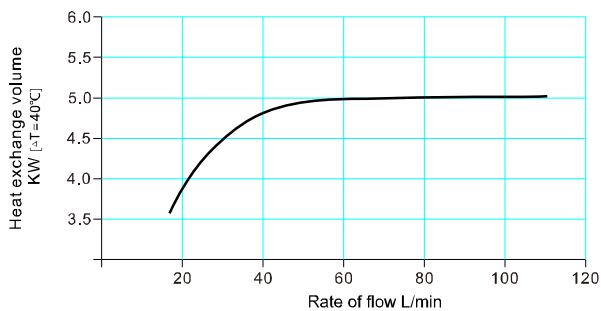

# AH Series Plate-Fin Hydraulic Aluminum Oil Coolers

## Specifications

## AH1012T-CA-100L



Model	AH1012T-CA	Cooling Capacity	5.8KW
Rate of flow	100L/min	Weight	12KG
Working pressure	≤2MPa	Packing size	44.5*37*22CM
Fan power	45W/52W	Fan voltage	AC110V/AC220V-240V/AC380V/50HZ
Exterior cooling area	3.2M <sup>2</sup>	Special voltage & size can be customized	

## Dimensions

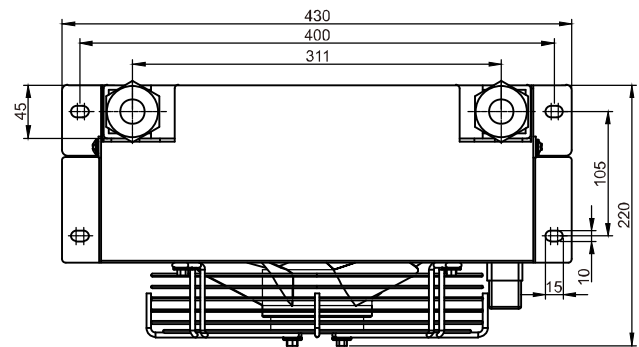
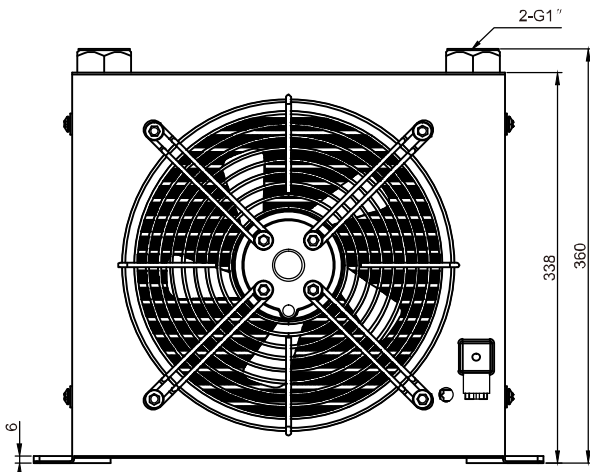

## Performance Curves

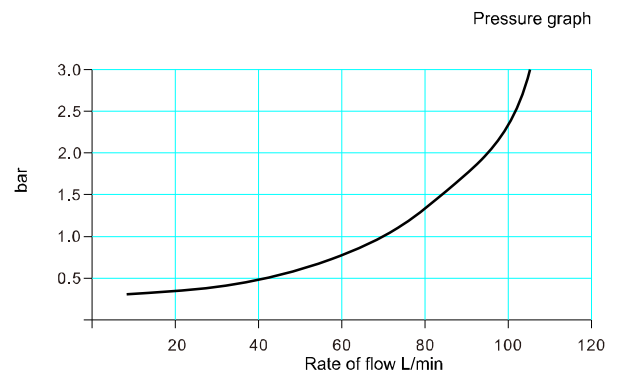
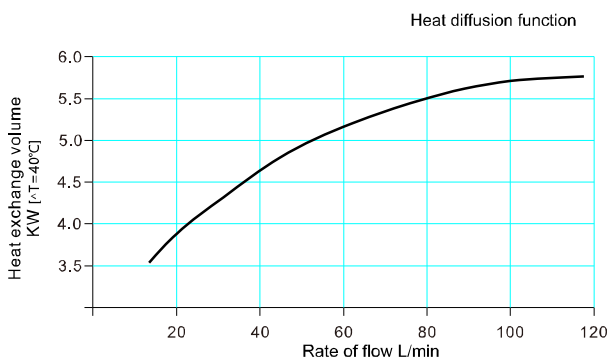

## AH Series Plate-Fin Hydraulic Aluminum Oil Coolers

### Specifications

### AH/AJ1012T-DC-100L



Model	AH/AJ1012T-CA	Cooling Capacity	5.8KW
Rate of flow	100L/min	Weight	12KG
Working pressure	≤2MPa	Packing size	44. 5*37*18CM
Fan power	45W/52W	Fan voltage	DC12V/DC24V
Exterior cooling area	3.2M <sup>2</sup>	Special voltage & size can be customized	

### Dimensions

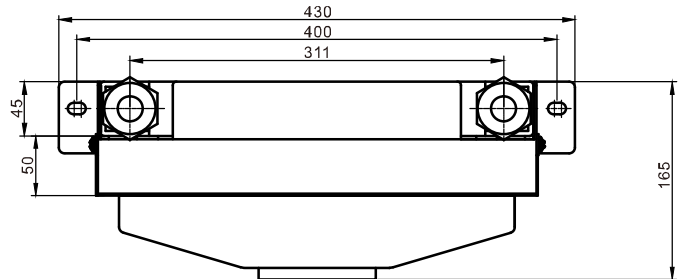
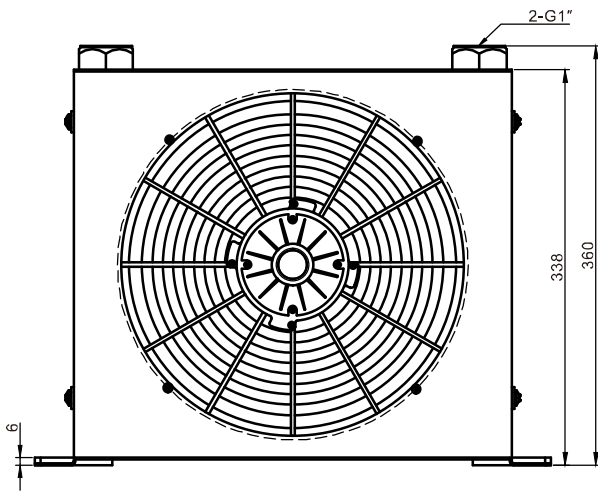

### Performance Curves

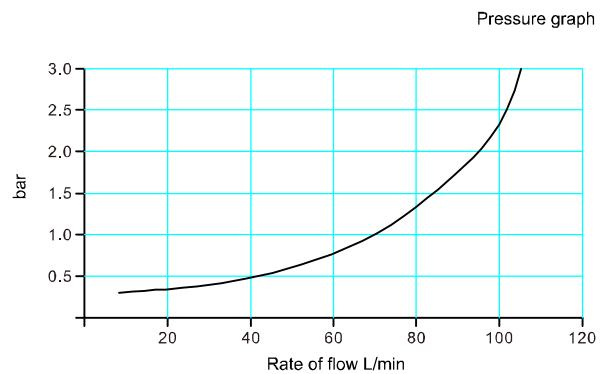
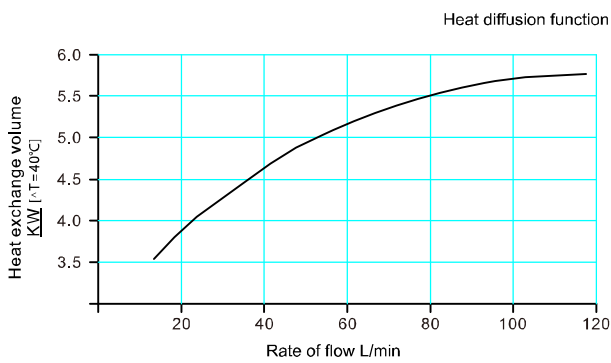

## AH Series Plate-Fin Hydraulic Aluminum Oil Coolers

### Specifications

### AH1417T-CA-150L

Model	AH1417T-CA	Cooling Capacity	8KW
Rate of flow	150L/min	Weight	25KG
Working pressure	≤2MPa	Packing size	58*45*38CM
Fan power	142W/135W	Fan voltage	AC110V/AC220V-240V/AC380V/50HZ
Exterior cooling area	6.2M <sup>2</sup>	Special voltage & size can be customized	



### Dimensions

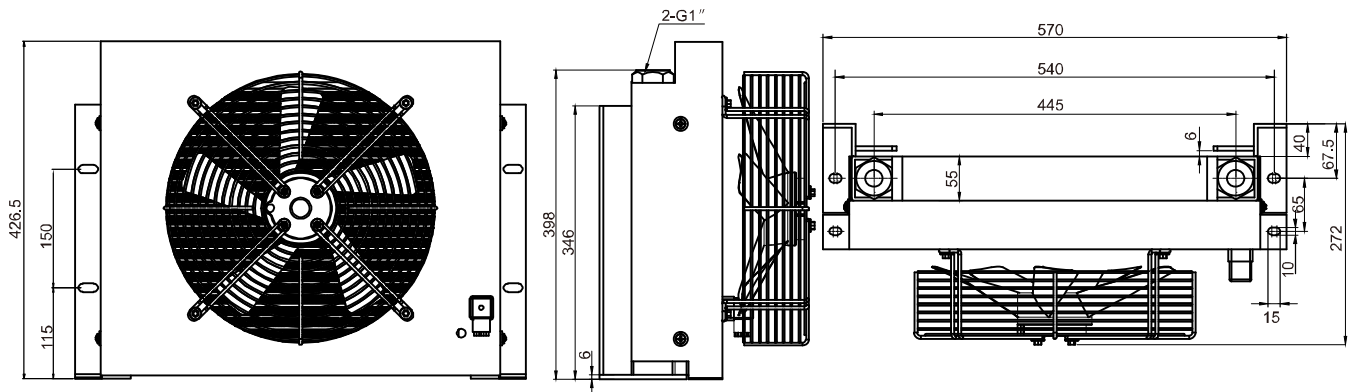

### Performance Curves

Heat diffusion function

Pressure graph

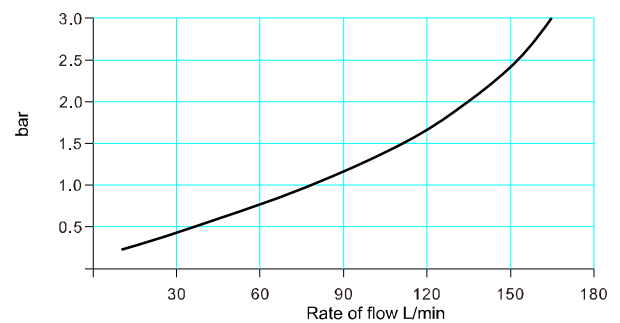
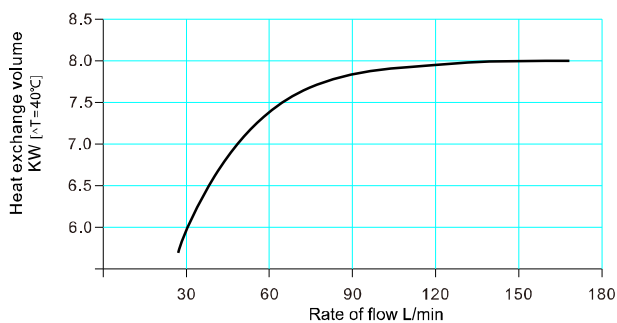

# AH Series Plate-Fin Hydraulic Aluminum Oil Coolers

## Specifications

## AH/AJ1417T-DC-150L



Model	AH/AJ1417T-CA	Cooling Capacity	8KW
Rate of flow	150L/min	Weight	25KG
Working pressure	≤2MPa	Packing size	58*45*30CM
Fan power	216W	Fan voltage	DC12V/DC24V
Exterior cooling area	6.2M <sup>2</sup>	Special voltage & size can be customized	

## Dimensions

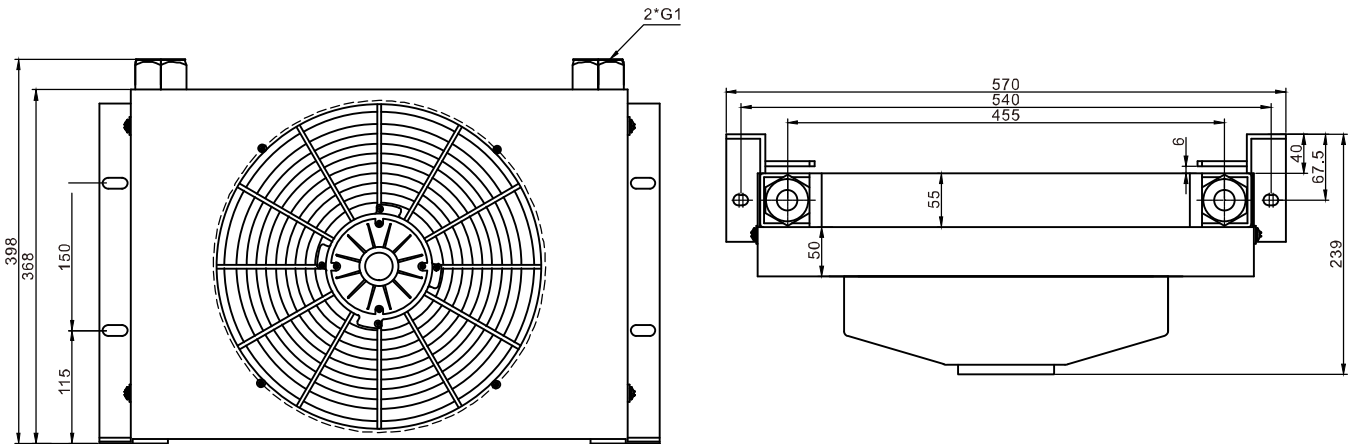

## Performance Curves

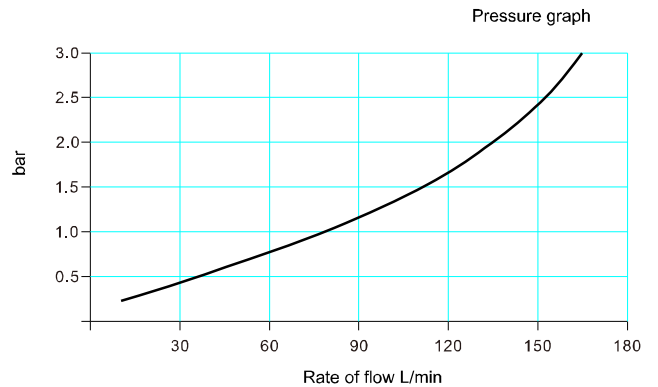
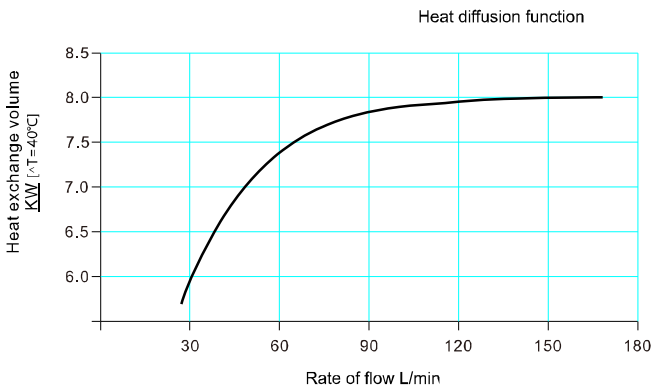

# AH Series Plate-Fin Hydraulic Aluminum Oil Coolers

## Specifications

### AH1470T-CA-200L



Model	AH1470T-CA	Cooling Capacity	8.8KW
Rate of flow	200L/min	Weight	26KG
Working pressure	≤2MPa	Packing size	58*45*38CM
Fan power	142W/135W	Fan voltage	AC110V/AC220V-240V/AC380V/ DC12V/DC24V/50HZ
Exterior cooling area	8.3M <sup>2</sup>	Special voltage & size can be customized	

## Dimensions

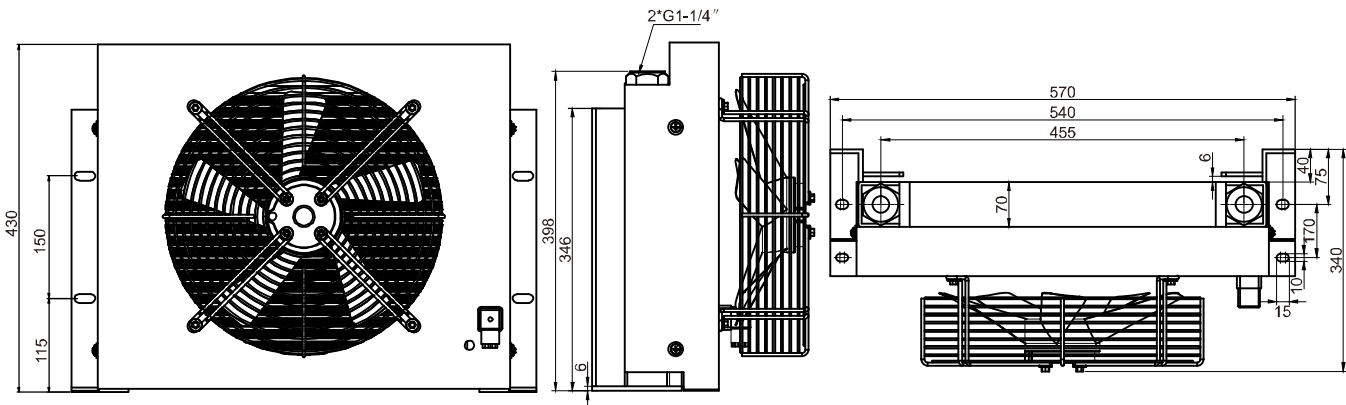

## Performance Curves

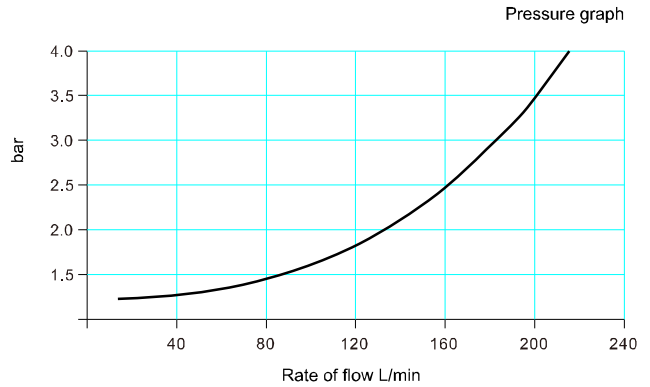
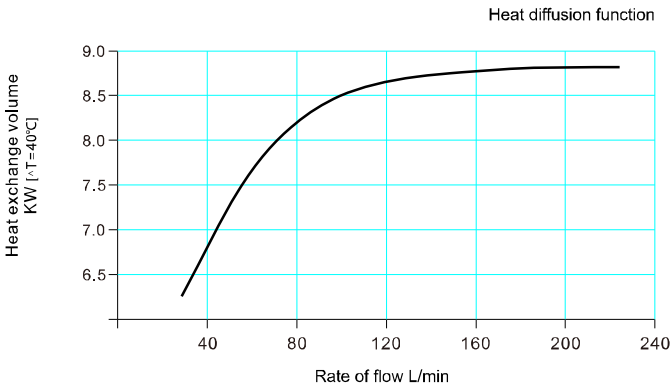

# AH Series Plate-Fin Hydraulic Aluminum Oil Coolers

## Specifications

## AH/AJ1470T-DC-200L



Model	AH/AJ1470T-CA	Cooling Capacity	8.8KW
Rate of flow	200L/min	Weight	26KG
Working pressure	≤2MPa	Packing size	58*45*30CM
Fan power	216W	Fan voltage	DC12V/DC24V
Exterior cooling area	8.3M <sup>2</sup>	Special voltage & size can be customized	

## Dimensions

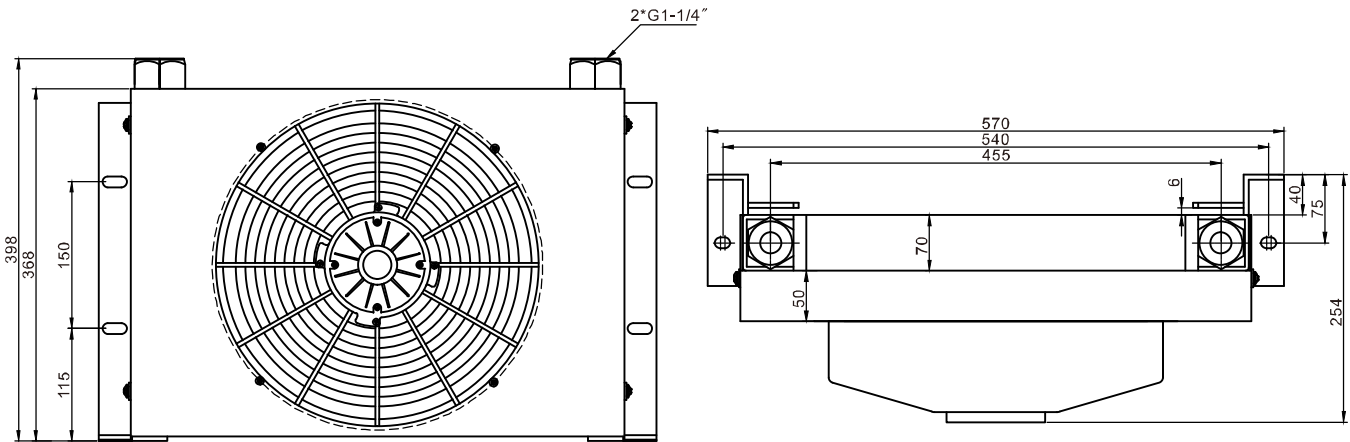

## Performance Curves

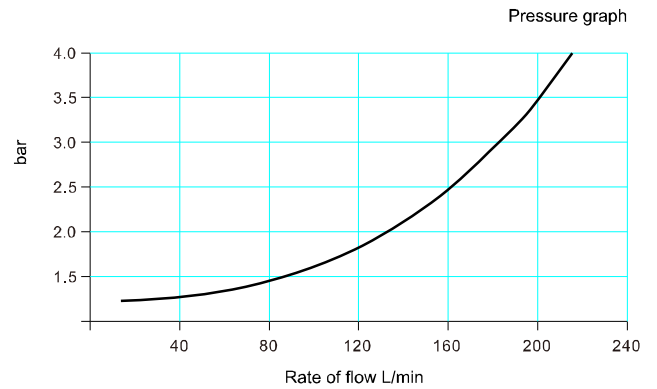
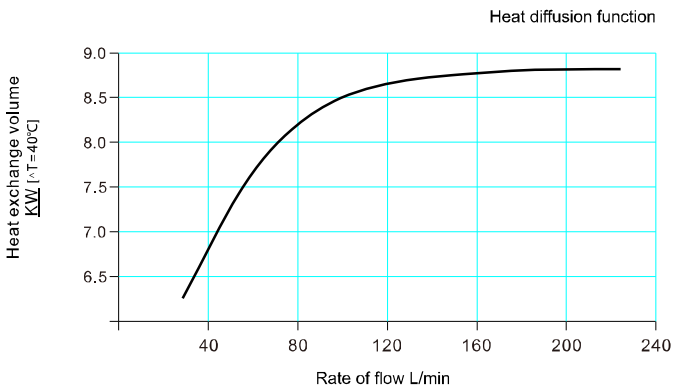

## AH Series Plate-Fin Hydraulic Aluminum Oil Coolers

### Specifications

### AH1490T-CA-250L

Model	AH1490T-CA	Cooling Capacity	11.5KW
Rate of flow	250L/min	Weight	29KG
Working pressure	≤2MPa	Packing size	58*45*38CM
Fan power	142W/135W	Fan voltage	AC220V-240V/AC380V/ 50HZ
Exterior cooling area	10.5M <sup>2</sup>	Special voltage & size can be customized	



### Dimensions

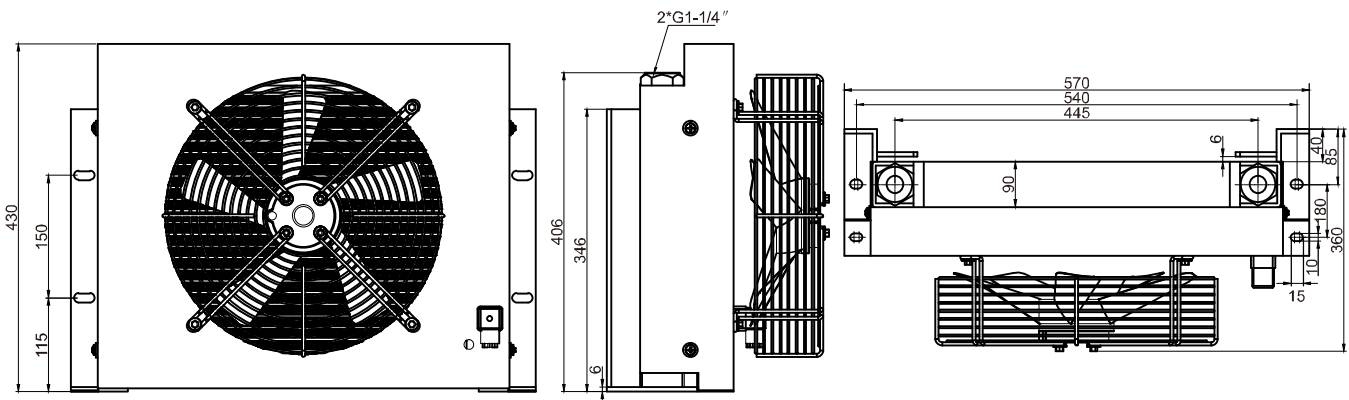

### Performance Curves

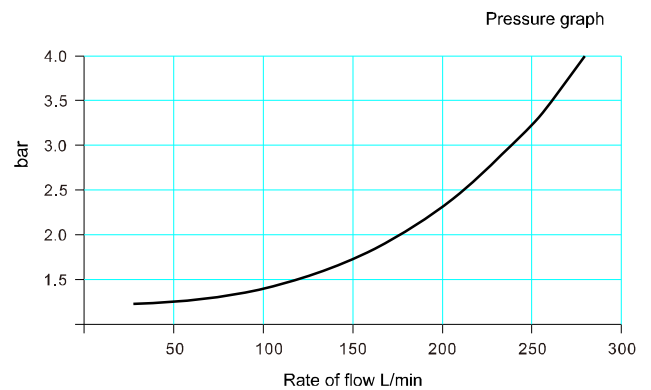
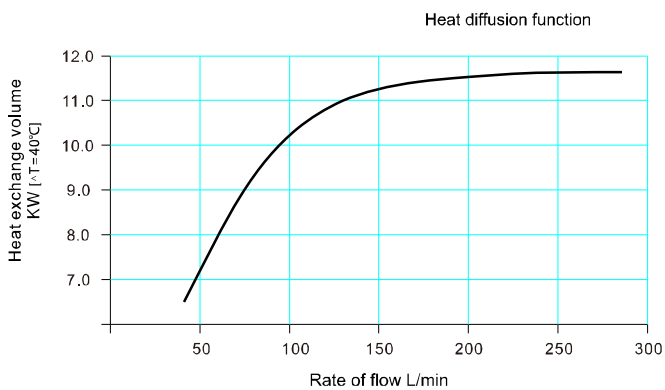



# AH Series Plate-Fin Hydraulic Aluminum Oil Coolers

## Specifications

## AH/AJ1490T-DC-250L



Model	AH/AJ1490T-CA	Cooling Capacity	11.5KW
Rate of flow	250L/min	Weight	29KG
Working pressure	≤2MPa	Packing size	58*45*38CM
Fan power	216W	Fan voltage	DC12V/DC24V
Exterior cooling area	10.5M <sup>2</sup>	Special voltage & size can be customized	

## Dimensions

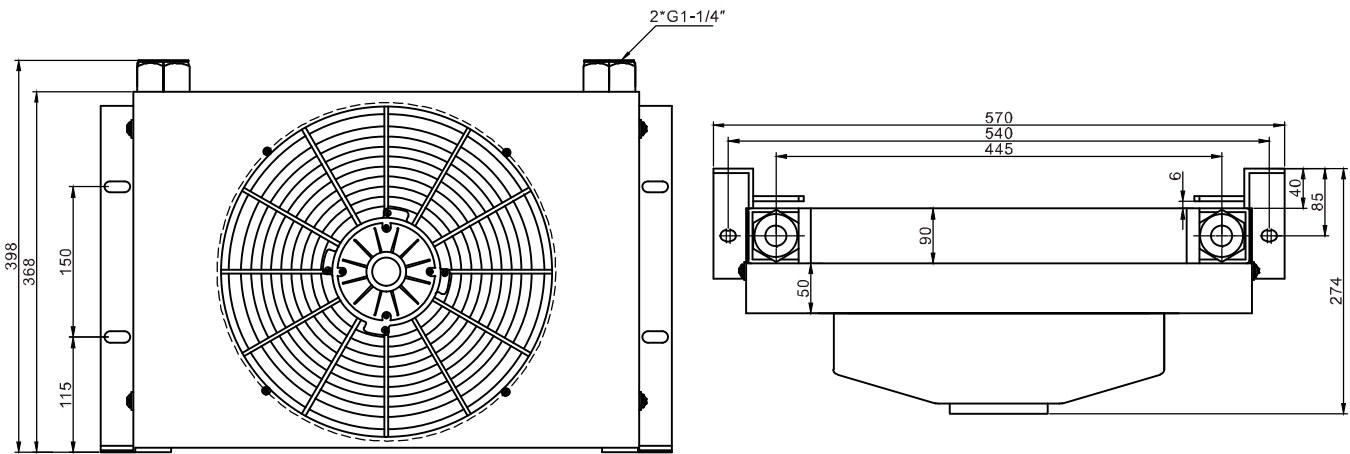

## Performance Curves

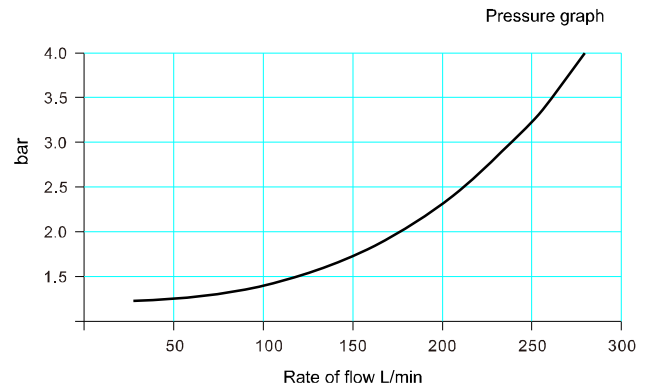
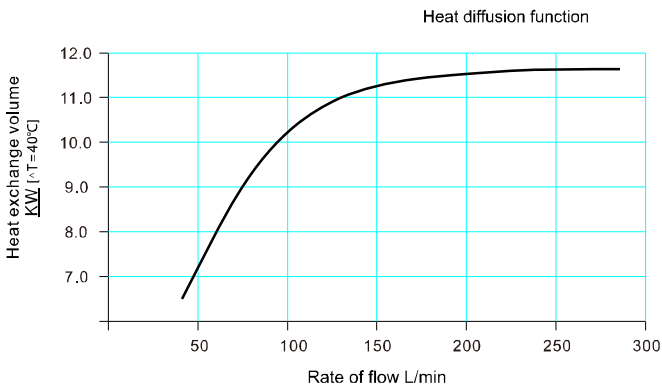

## AH Series Plate-Fin Hydraulic Aluminum Oil Coolers

### Specifications

### AH1680T-CA-300L



Model	AH1680T-CA	Cooling Capacity	19KW
Rate of flow	300L/min	Weight	55KG
Working pressure	≤2MPa	Packing size	85*66*42CM
Fan power	423W/448W	Fan voltage	AC220V-240V/AC380V/DC12V/ DC24V/50HZ
Exterior cooling area	14M <sup>2</sup>	Special voltage & size can be customized	

### Dimensions

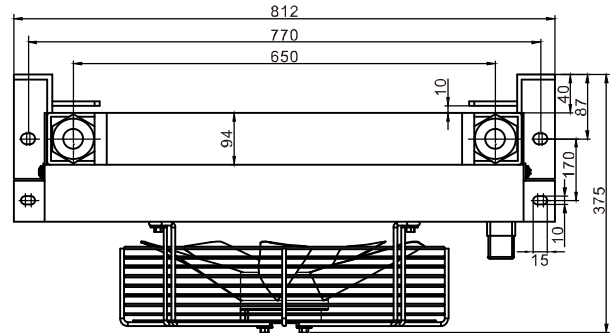
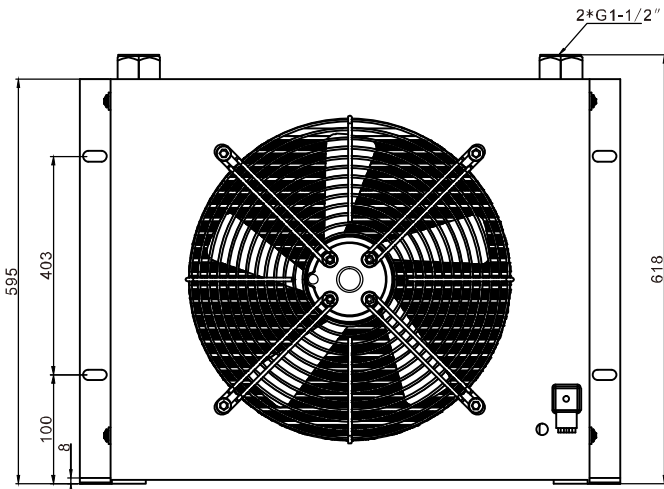

### Performance Curves

Heat diffusion function

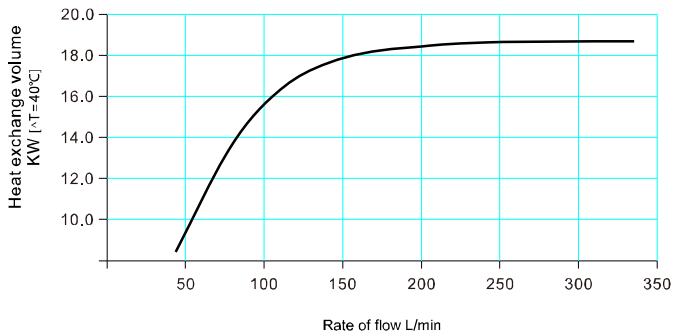

Pressure graph

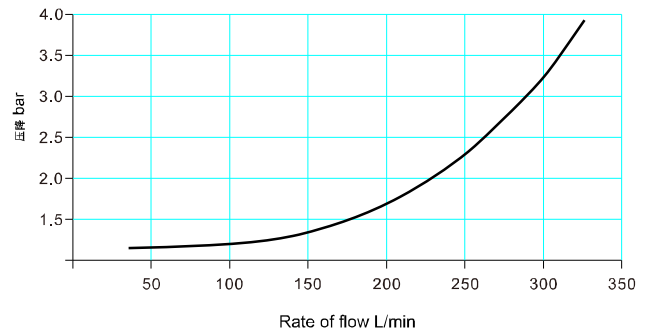

# AH Series Plate-Fin Hydraulic Aluminum Oil Coolers

## Specifications

## AH2431T-CA-450L

Model	AH2431T-CA	Cooling Capacity	34KW
Rate of flow	450L/min	Weight	73KG
Working pressure	≤2MPa	Packing size	95*75*43CM
Fan power	836W	Fan voltage	AC380V/50HZ
Exterior cooling area	33.2M <sup>2</sup>	Special voltage & size can be customized	



## Dimensions

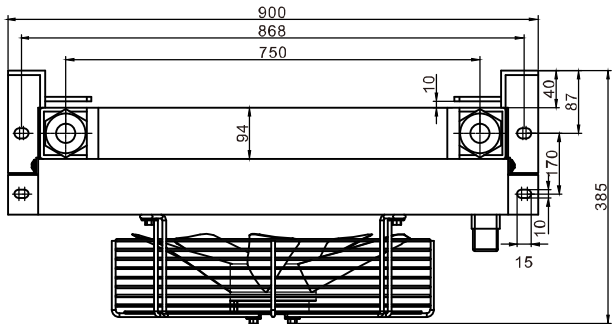
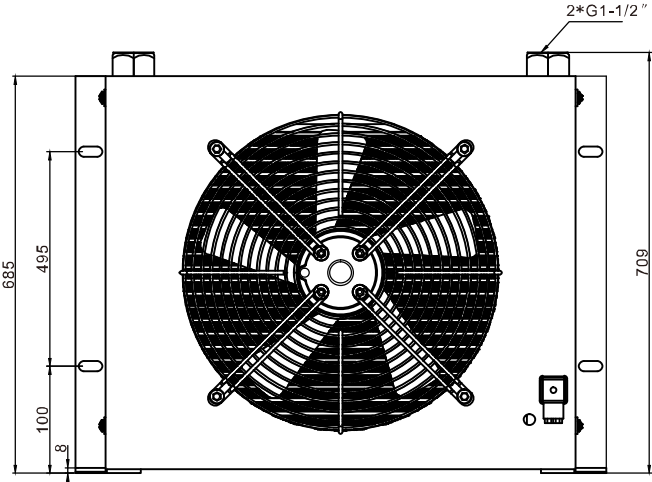

## Performance Curves

Heat diffusion function

Pressure graph

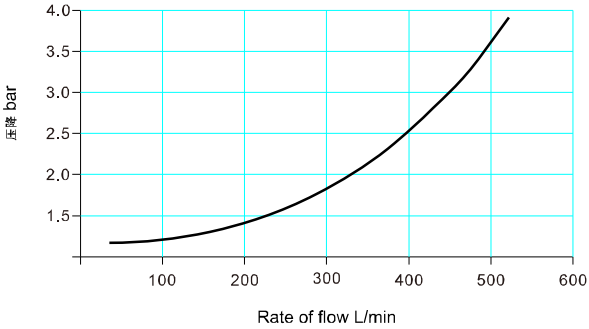
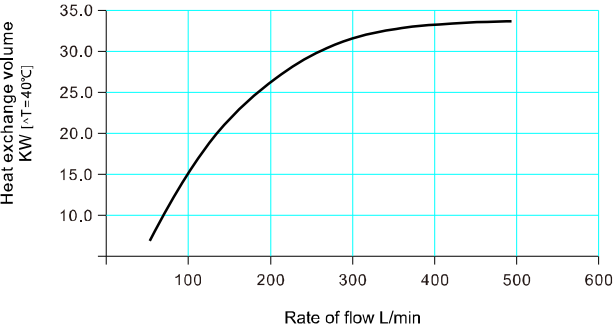

## AH Series Plate-Fin Hydraulic Aluminum Oil Coolers

### Specifications

### AH1890T-CA-250L



Model	AH1890T-CA	Cooling Capacity	26KW
Rate of flow	250L/min	Weight	
Working pressure	≤2MPa	Packing size	85*68*35CM
Fan power	2*150W	Fan voltage	AC220V/AC380V/50HZ
Exterior cooling area	15.8M <sup>2</sup>	Special voltage & size can be customized	

### Dimensions

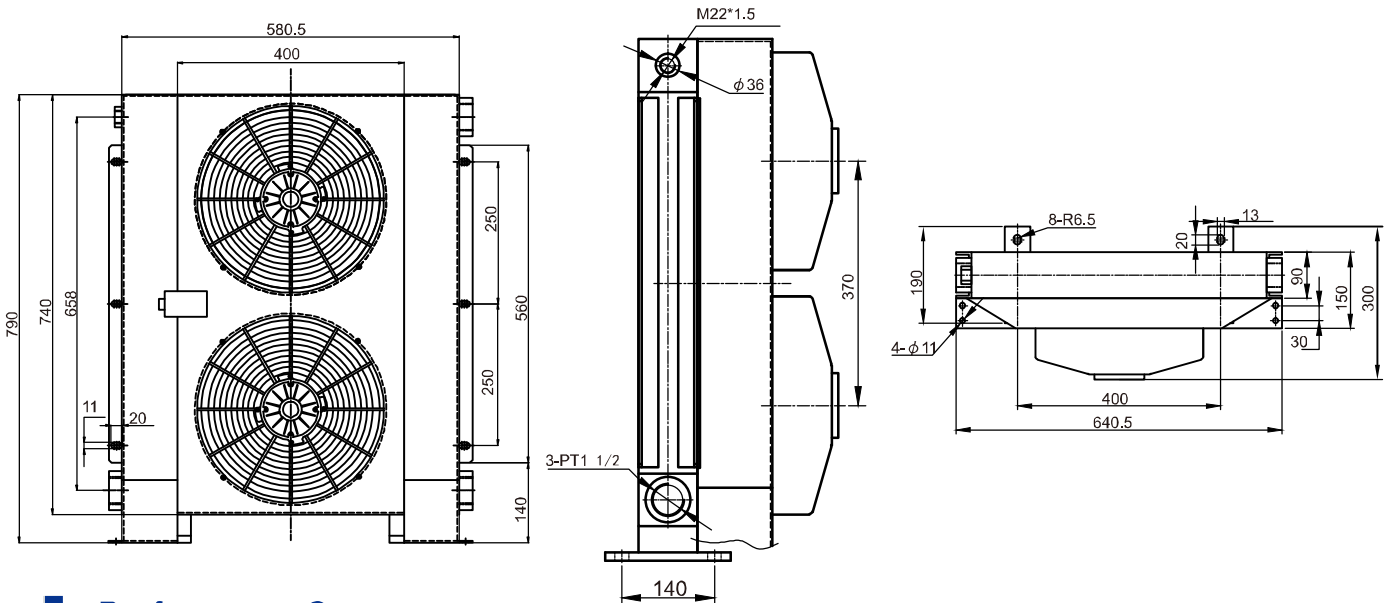

### Performance Curves

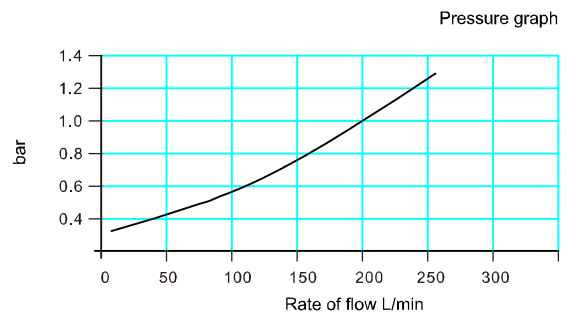
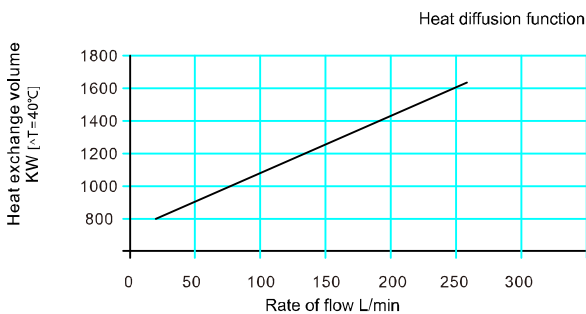

## SQ Series Plate-Fin Hydraulic Aluminum Oil Coolers

### Specifications

**SQ1015T-CA-20L**

Model	SQ1015T-CA	Cooling Capacity	1.2KW
Rate of flow	20L/min	Weight	3.5KG
Working pressure	≤2MPa	Packing size	21*20.5*15CM
Fan power	34W	Fan voltage	AC110V/AC220V-240V/AC380V/ DC12V/DC24V/50HZ
Exterior cooling area	0.6M <sup>2</sup>	Special voltage & size can be customized	



### Dimensions

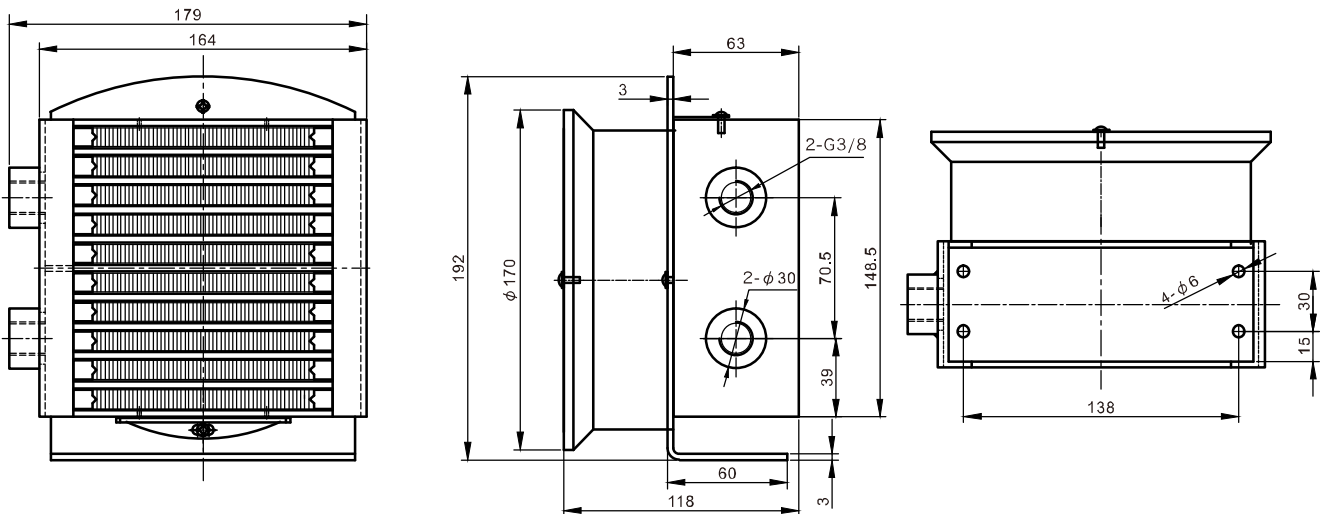

### Performance Curves

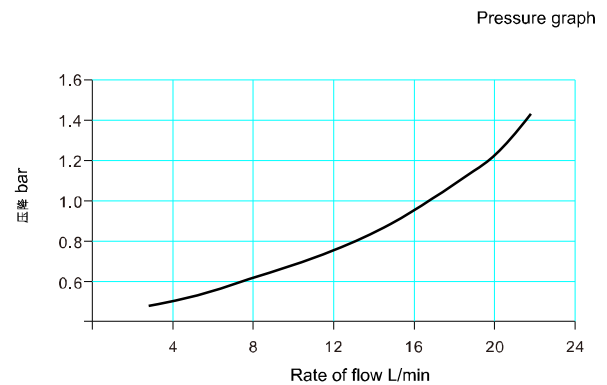
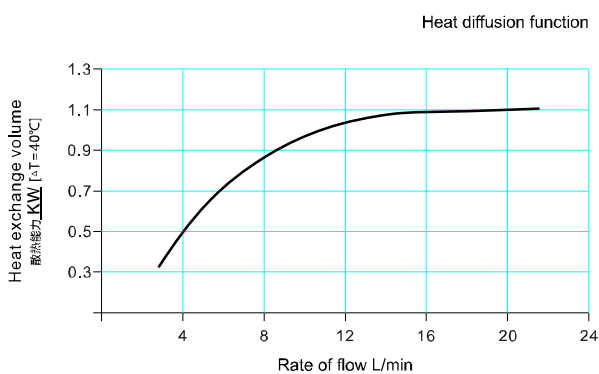

## ECO Series Plate-Fin Hydraulic Aluminum Oil Coolers

### Specifications

**ECO-04-80L**



Model	ECO-04	Cooling Capacity	3.5KW
Rate of flow	80L/min	Weight	7KG
Working pressure	≤2MPa	Packing size	35*28*19CM
Fan power	100W	Fan voltage	DC12V/DC24V/50HZ Special voltage & size can be customized
Exterior cooling area	1.1M <sup>2</sup>	Thermostat	Operational Temperature 50°C (Tolerance ±3°C)

### Dimensions

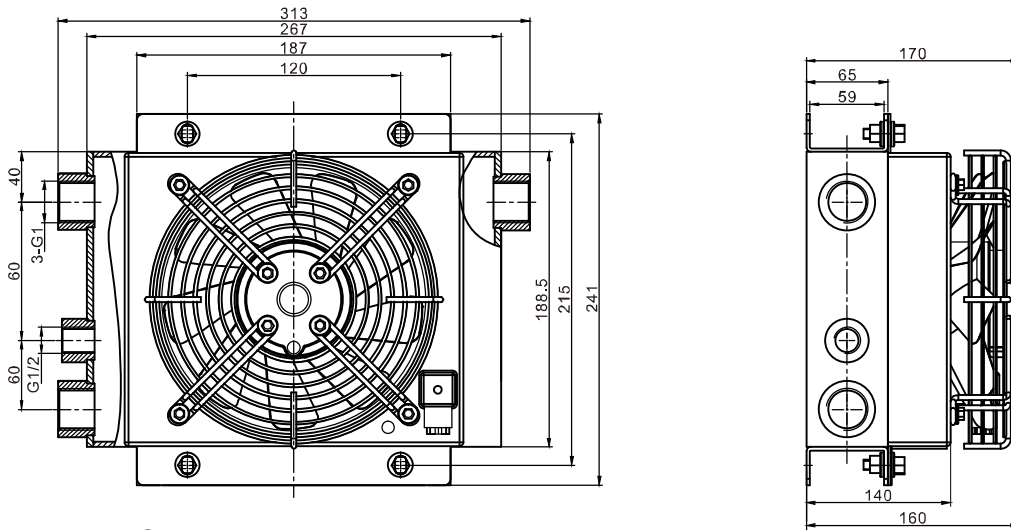

### Performance Curves

Heat diffusion function

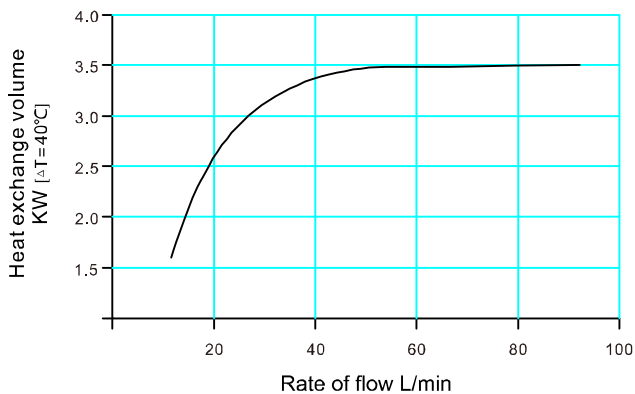

Pressure graph

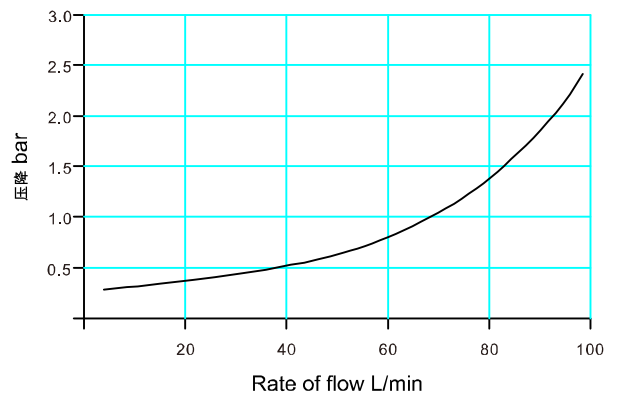

## ECO Series Plate-Fin Hydraulic Aluminum Oil Coolers

### Specifications

**ECO-07-120L**

Model	ECO-07	Cooling Capacity	5.5KW
Rate of flow	120L/min	Weight	9KG
Working pressure	≤2MPa	Packing size	40.5*34.5*18.5CM
Fan power	100W	Fan voltage	DC12V/DC24V/50HZ Special voltage & size can be customized
Exterior cooling area	2.2M <sup>2</sup>	Thermostat	Operational Temperature 50°C (Tolerance ±3°C)



### Dimensions

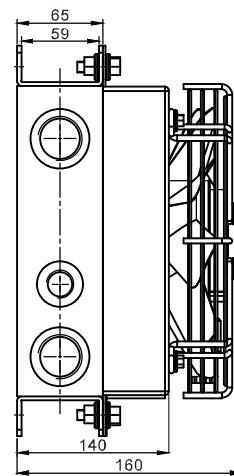
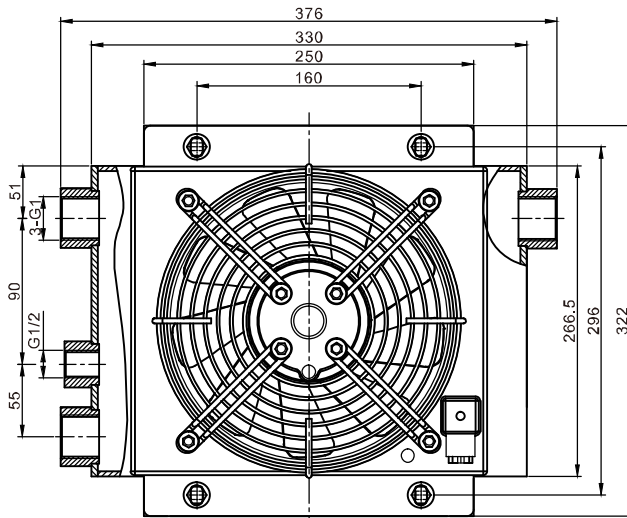

### Performance Curves

Heat diffusion function

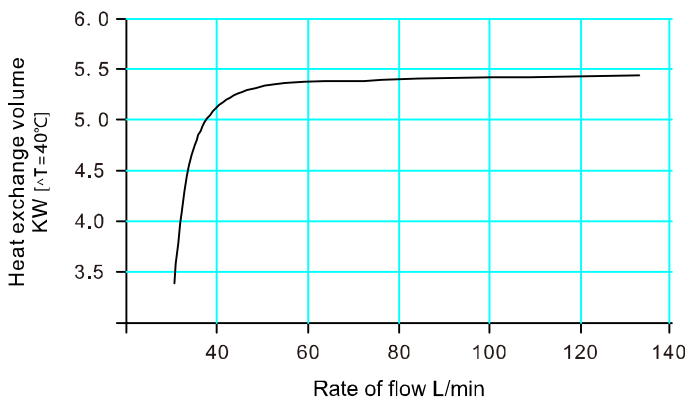

Pressure graph

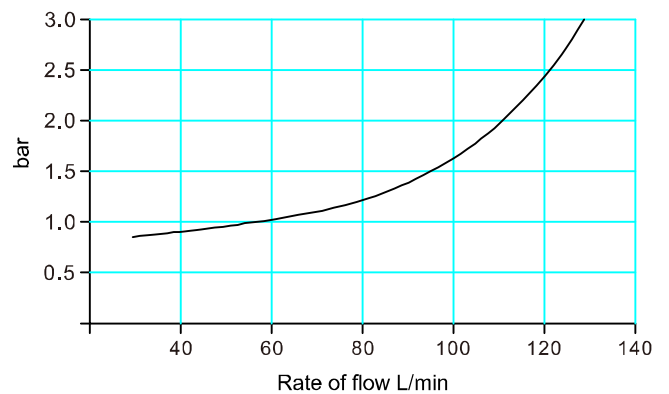

## FR Series Plate-Fin Hydraulic Aluminum Oil Coolers

### Specifications

**FR-02-60L**



Model	FR-02	Cooling Capacity	2.8KW
Rate of flow	60L/min	Weight	5KG
Working pressure	≤2MPa	Packing size	27.5*21*16.5CM
Fan power	34W	Fan voltage	AC220V-240V/DC12V/DC24V/50HZ Special voltage & size can be customized
Exterior cooling area	0.7M <sup>2</sup>	Thermostat	Operational Temperature 50°C (Tolerance ±3°C)

### Dimensions

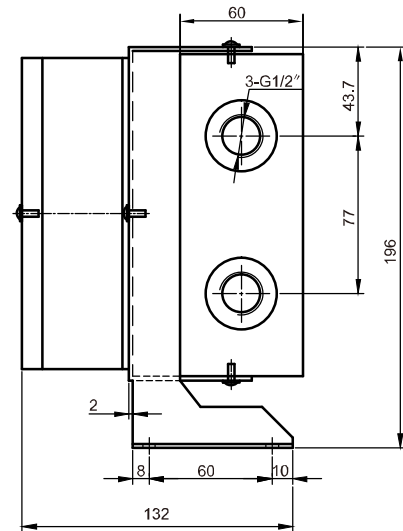
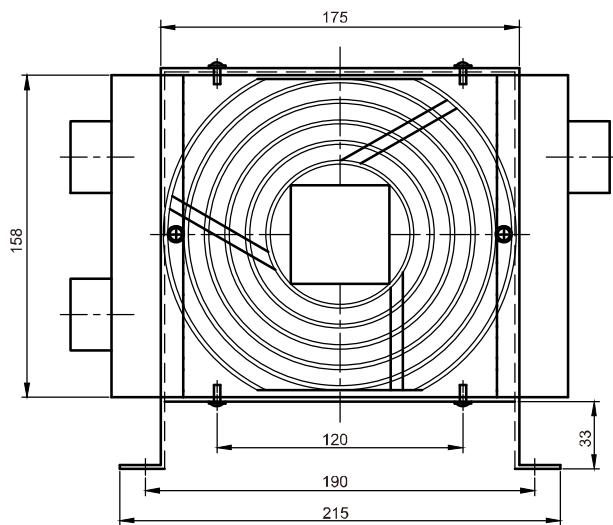

### Performance Curves

Heat diffusion function

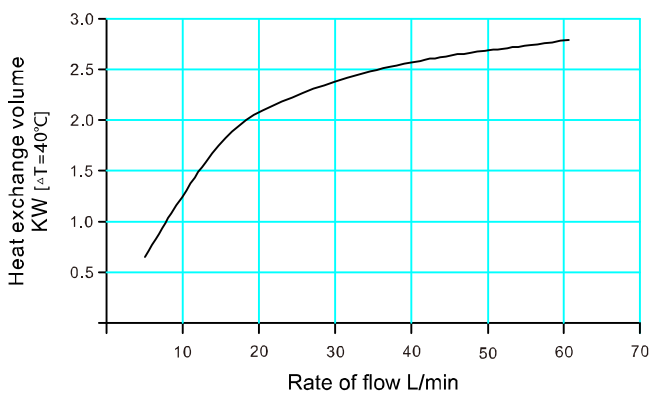

Pressure graph

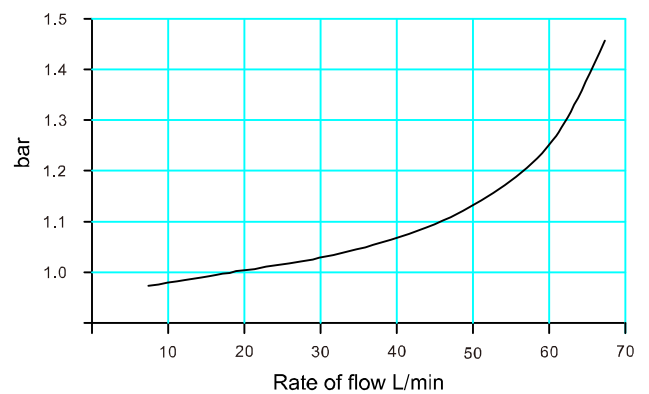



## FR Series Plate-Fin Hydraulic Aluminum Oil Coolers

### Specifications

FR-03-80L

Model	FR-03	Cooling Capacity	3.3KW
Rate of flow	80L/min	Weight	7.8KG
Working pressure	≤2MPa	Packing size	34*27*23CM
Fan power	50W	Fan voltage	AC220V-240V/DC12V/DC24V/50HZ Special voltage & size can be customized
Exterior cooling area	0.9M <sup>2</sup>	Thermostat	Operational Temperature 50°C (Tolerance ±3°C)



### Dimensions

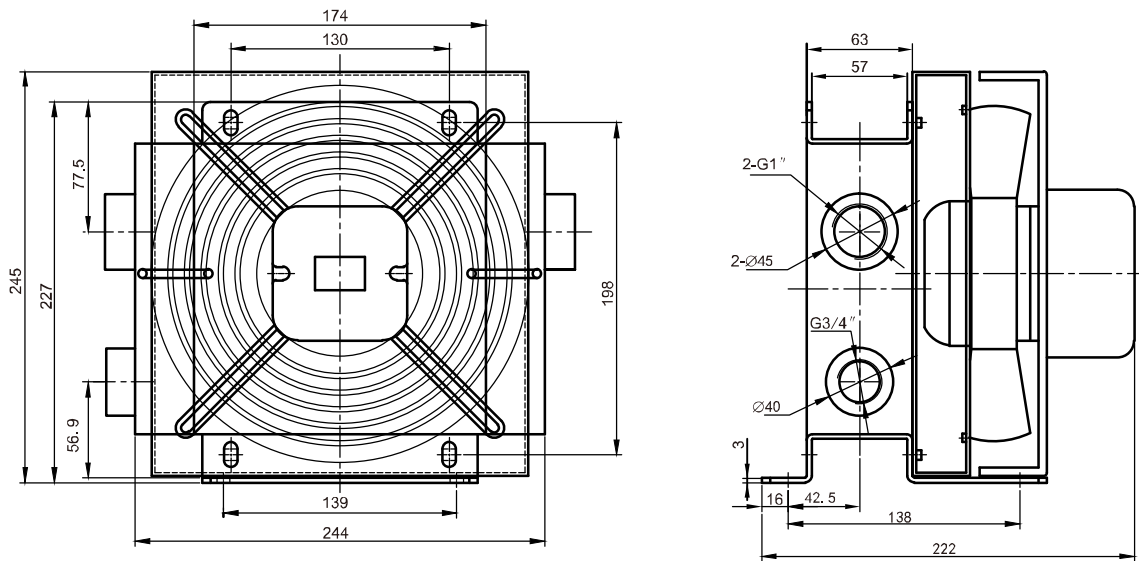

### Performance Curves

Heat diffusion function

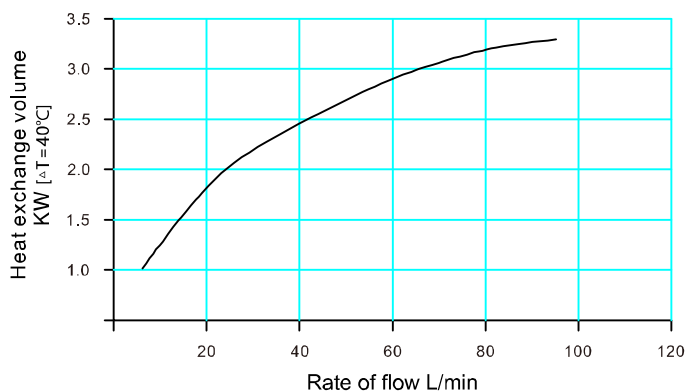

Pressure graph

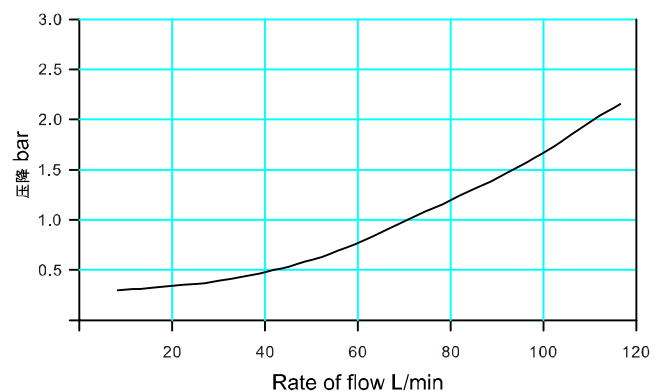

## FR Series Plate-Fin Hydraulic Aluminum Oil Coolers

### Specifications

**FR-04-100L**



Model	FR-04	Cooling Capacity	4.6KW
Rate of flow	100L/min	Weight	9.1KG
Working pressure	≤2MPa	Packing size	34*27*23CM
Fan power	50W	Fan voltage	AC220V-240V/DC12V/DC24V/50HZ Special voltage & size can be customized
Exterior cooling area	1.1M <sup>2</sup>	Thermostat	Operational Temperature 50°C (Tolerance ± 3°C)

### Dimensions

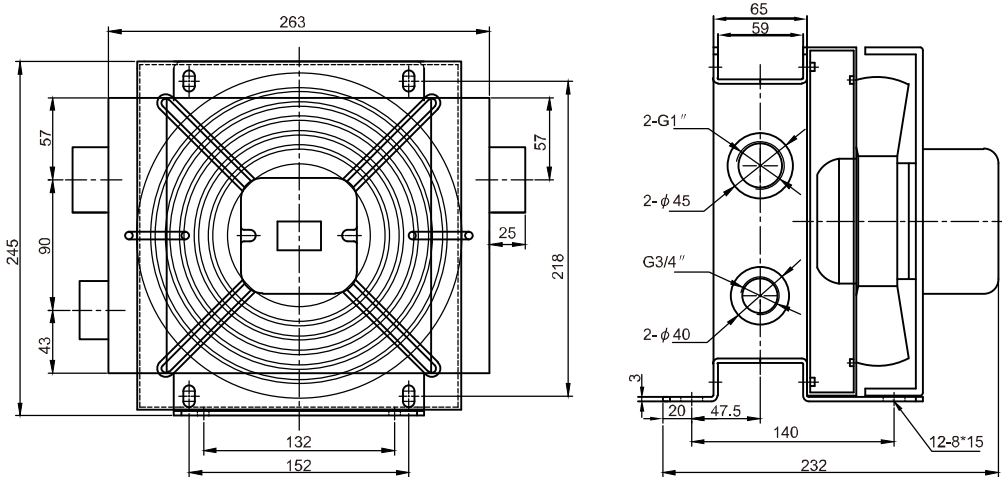

### Performance Curves

Heat diffusion function

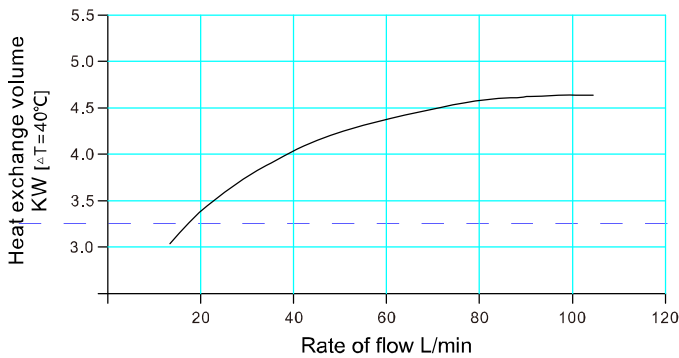

Pressure graph

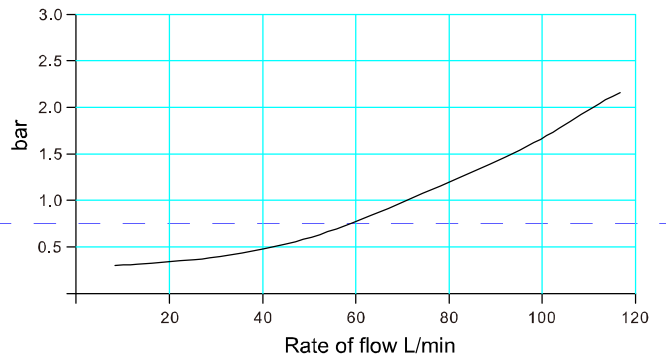

## FR Series Plate-Fin Hydraulic Aluminum Oil Coolers

### Specifications

FR-05-120L



Model	FR-05	Cooling Capacity	5.7KW
Rate of flow	120L/min	Weight	10KG
Working pressure	≤2MPa	Packing size	37*30*29CM
Fan power	50W	Fan voltage	AC220V-240V/DC12V/DC24V/50HZ Special voltage & size can be customized
Exterior cooling area	1.3M <sup>2</sup>	Thermostat	Operational Temperature 50°C (Tolerance ±3°C)

### Dimensions

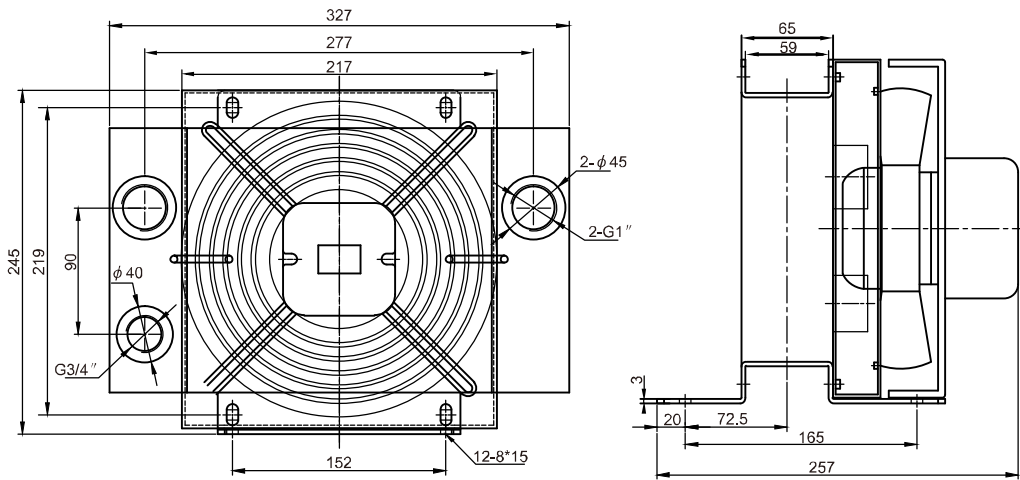

### Performance Curves

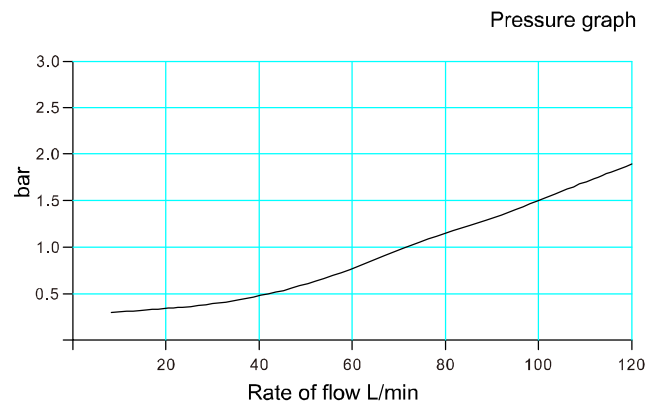
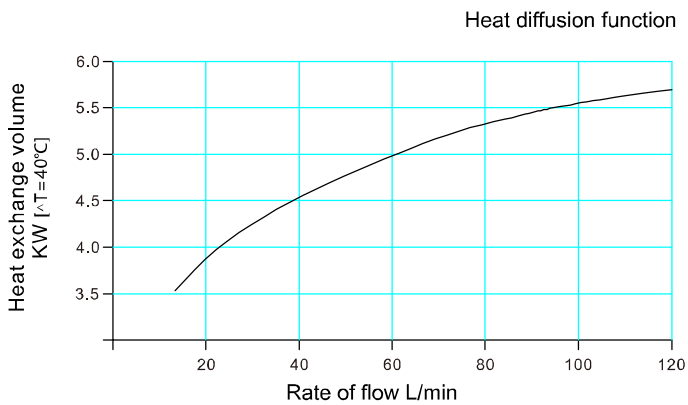

## LOC Series Plate-Fin Hydraulic Aluminum Oil Coolers

### Specifications

**LOC-004-20L**



Model	LOC-004	Cooling Capacity	1.3KW
Rate of flow	20L/min	Weight	6KG
Working pressure	≤2MPa	Packing size	35*30*20CM
Fan power	40W	Fan voltage	AC220V-240V/DC12V/DC24V/50HZ Special voltage & size can be customized
Exterior cooling area	1M <sup>2</sup>	Thermostat	Operational Temperature 50°C (Tolerance ±3°C)

### Dimensions

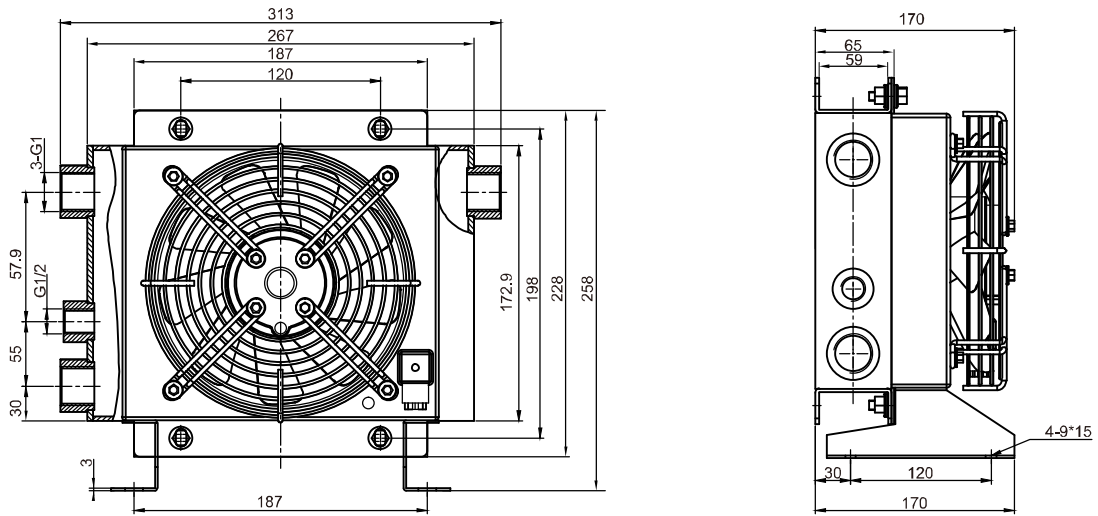

### Performance Curves

Heat diffusion function

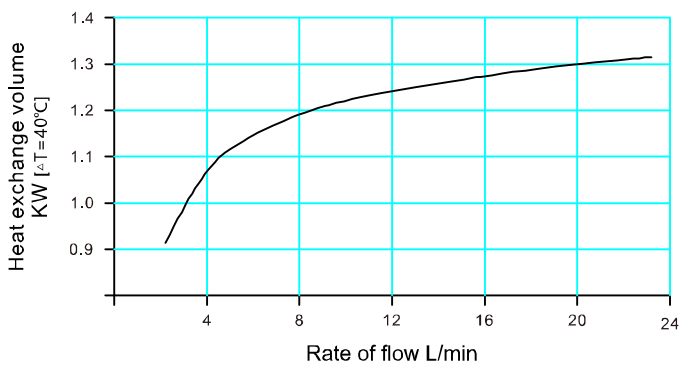

Pressure graph

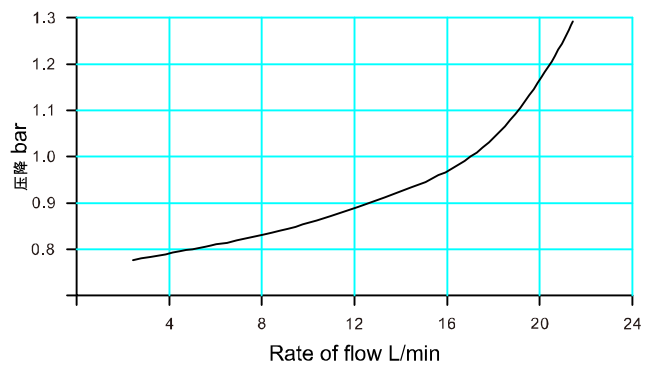

## LOC Series Plate-Fin Hydraulic Aluminum Oil Coolers

### Specifications

**LOC-007-80L**



Model	LOC-007	Cooling Capacity	1.45KW
Rate of flow	80L/min	Weight	9KG
Working pressure	≤2MPa	Packing size	42*36*20CM
Fan power	40W	Fan voltage	AC220V-240V/DC12V/DC24V/50HZ Special voltage & size can be customized
Exterior cooling area	1.9M <sup>2</sup>	Thermostat	Operational Temperature 50°C (Tolerance ± 3°C)

### Dimensions

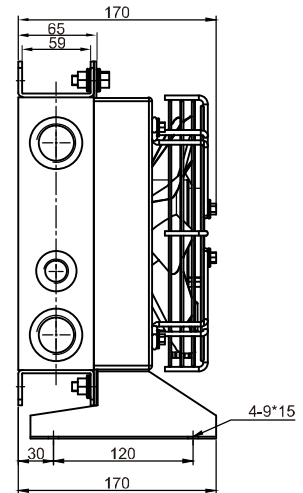
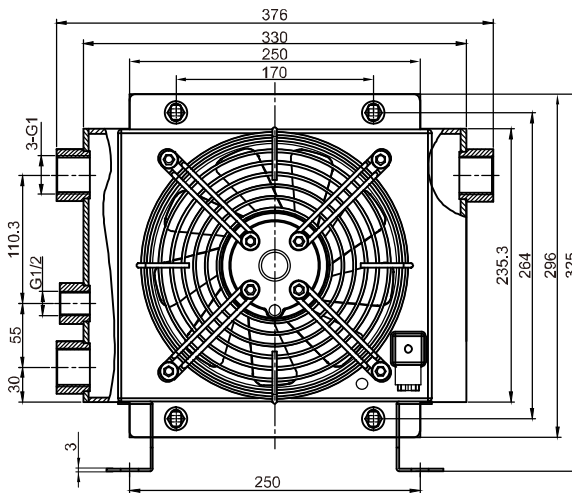

### Performance Curves

Heat diffusion function

Pressure graph

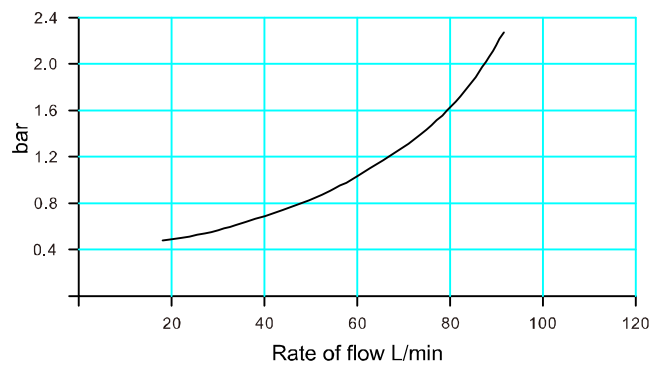
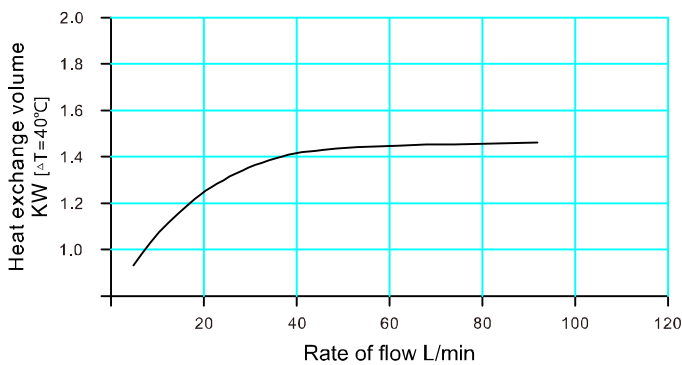

## LOC series oil cooler with motor

### Specifications

**LOC-011-100L**



Model	LOC-011	Cooling Capacity	4.7KW
Rate of flow	100L/min	Weight	12KG
Working pressure	≤2MPa	Packing size	47*40.5*20CM
Fan power	50W	Fan voltage	AC220V-240V/DC12V/DC24V/50HZ Special voltage & size can be customized
Exterior cooling area	3.2M <sup>2</sup>	Thermostat	Operational Temperature 50°C (Tolerance ±3°C)

### Dimensions

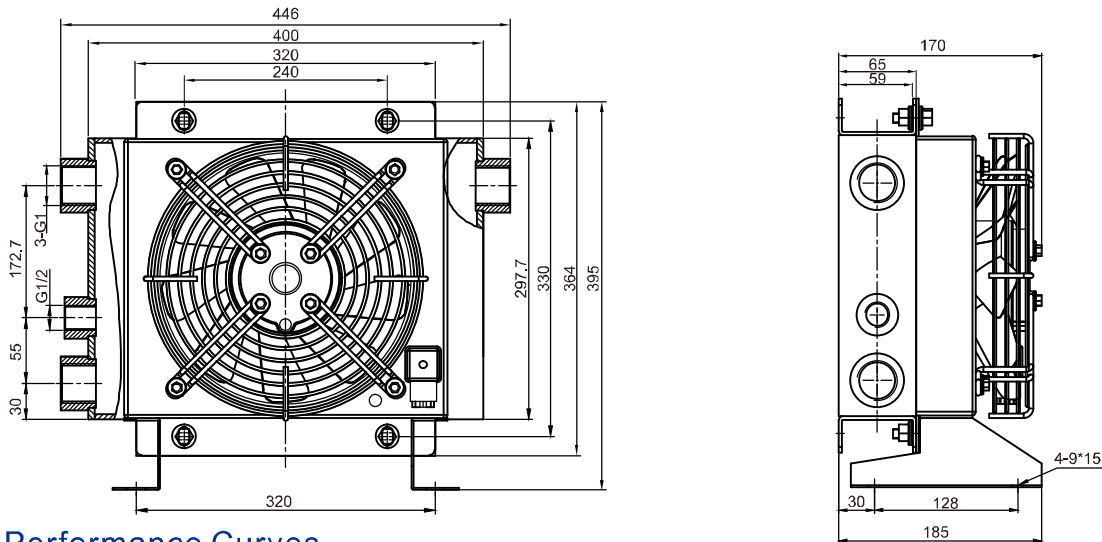

### Performance Curves

Heat diffusion function

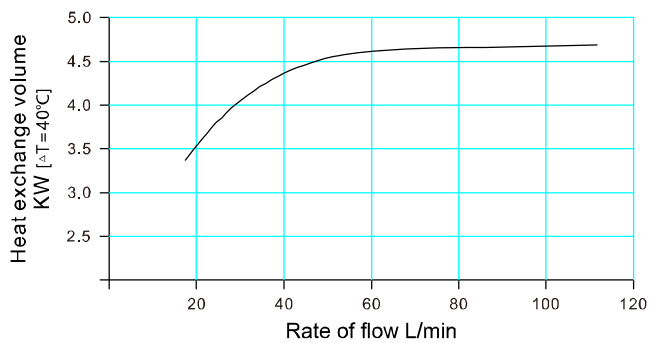

Pressure graph

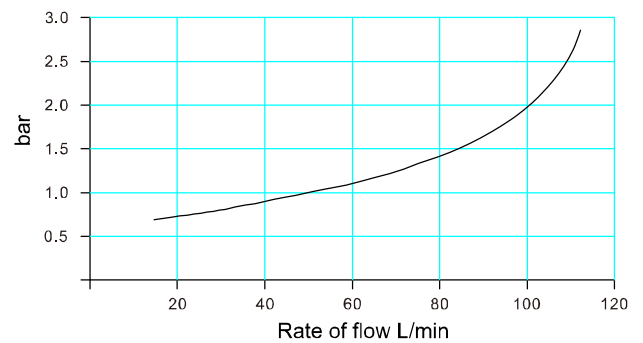

## LOC series oil cooler with motor

### Specifications

**LOC-016-120L**



Model	LOC-016	Cooling Capacity	6.5KW
Rate of flow	120L/min	Weight	18KG
Working pressure	≤2MPa	Packing size	55*50*26CM
Fan power	140W	Fan voltage	AC220V-240V/DC12V/DC24V/50HZ Special voltage & size can be customized
Exterior cooling area	4.8M <sup>2</sup>	Thermostat	Operational Temperature 50°C (Tolerance ±3°C)

### Dimensions

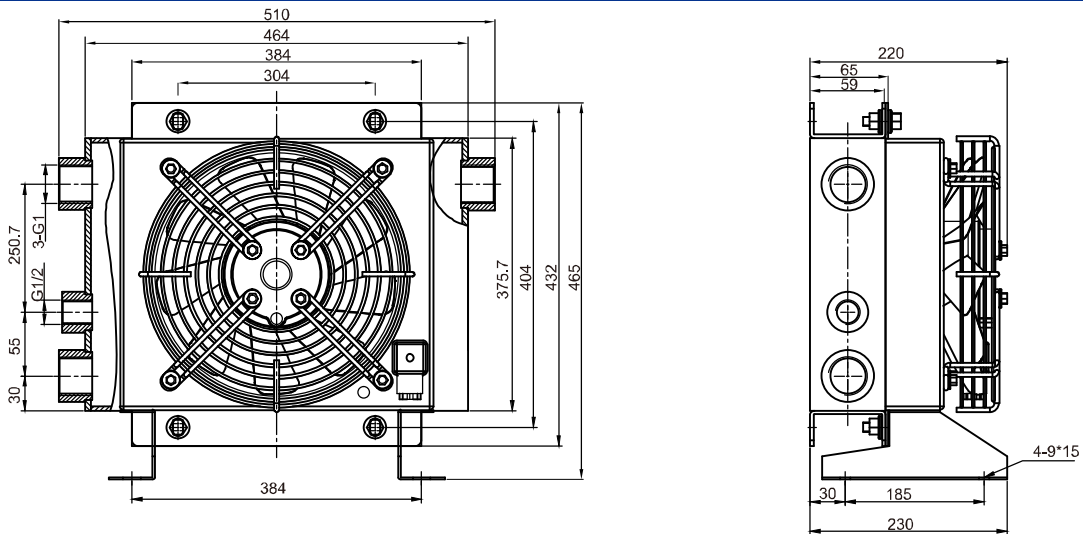

### Performance Curves

Heat diffusion function

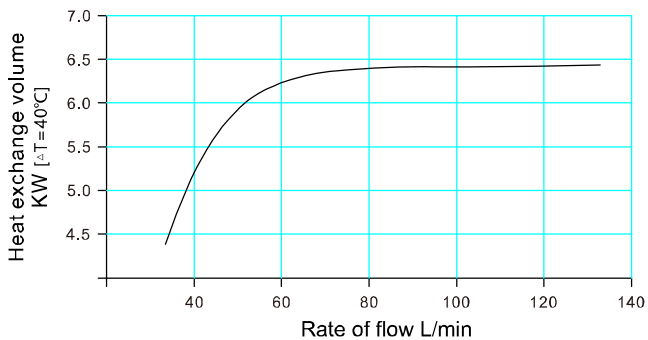

Pressure graph

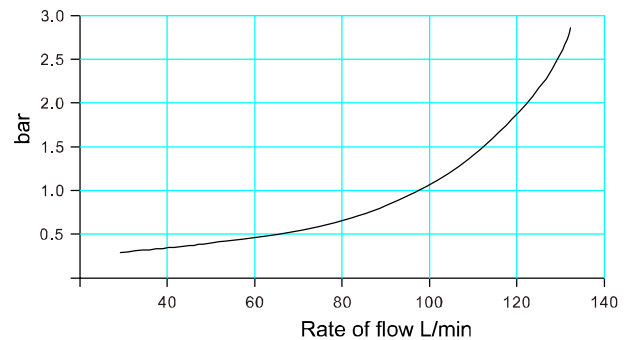

## LOC series oil cooler with motor

### Specifications

### LOC-023-180L



Model	LOC-023	Cooling Capacity	11.5KW
Rate of flow	180L/min	Weight	25KG
Working pressure	≤2MPa	Packing size	63*58*28CM
Fan power	180W	Fan voltage	AC220V-240V/DC12V/DC24V/50HZ Special voltage & size can be customized
Exterior cooling area	7.1M <sup>2</sup>	Thermostat	Operational Temperature 50°C (Tolerance ±3°C)

### Dimensions

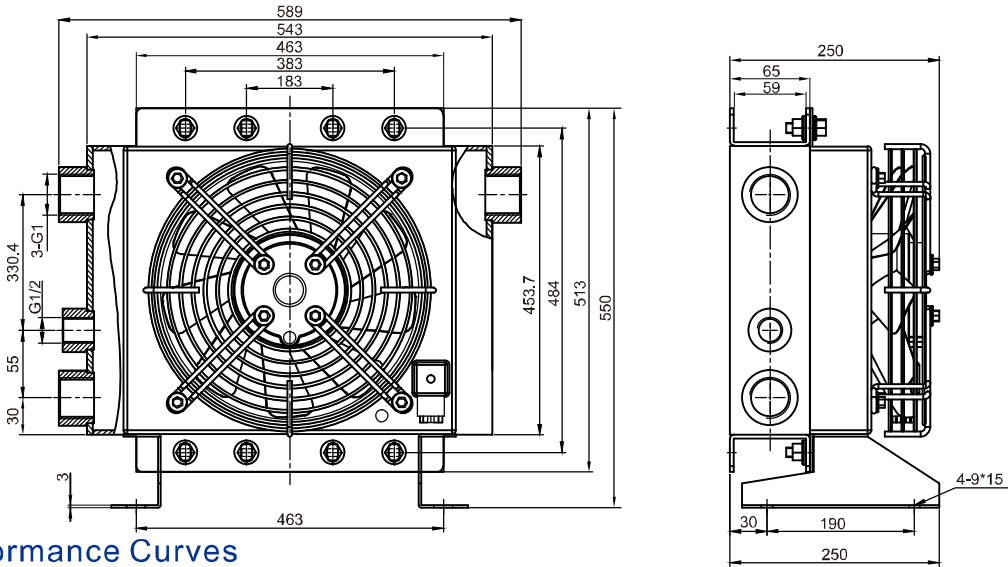

### Performance Curves

Heat diffusion function

Pressure graph

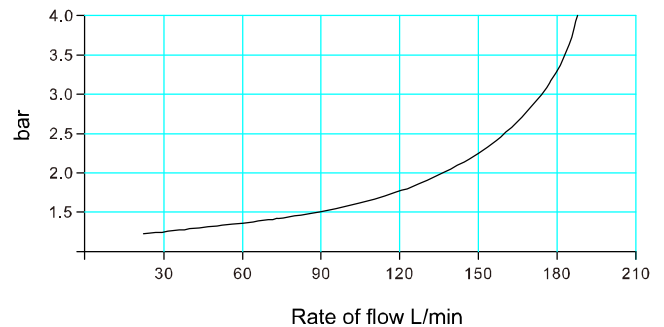
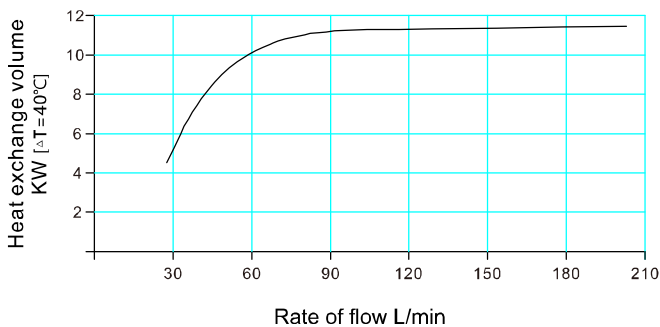



## LOC series oil cooler with motor

### Specifications

**LOC-033-240L**



Model	LOC-033	Cooling Capacity	13KW
Rate of flow	240L/min	Weight	33KG
Working pressure	≤2MPa	Packing size	72*58*29CM
Fan power	180W	Fan voltage	AC220V-240V/DC12V/DC24V/50HZ Special voltage & size can be customized
Exterior cooling area	11M <sup>2</sup>	Thermostat	Operational Temperature 50°C (Tolerance ± 3°C)

### Dimensions

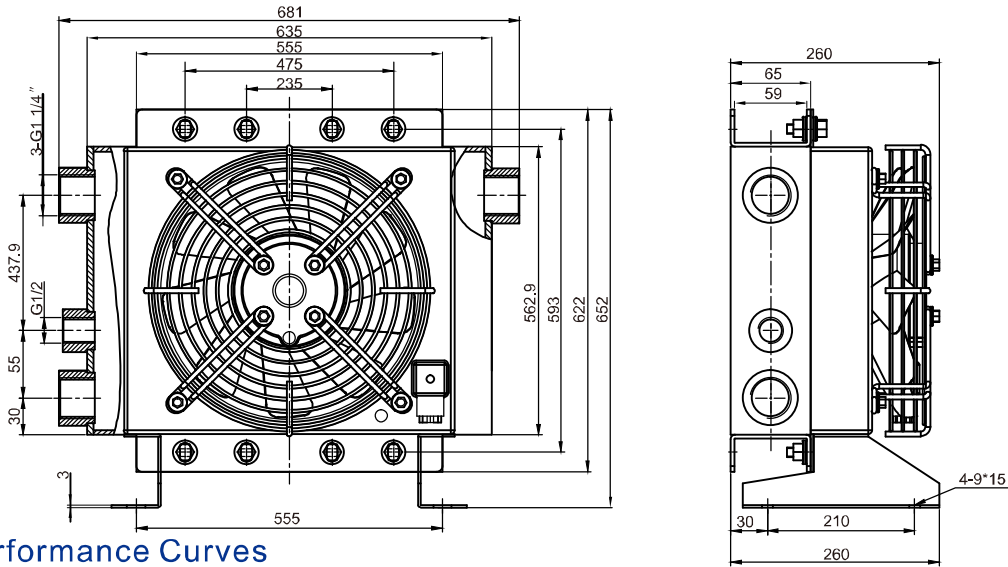

### Performance Curves

Heat diffusion function

Pressure graph

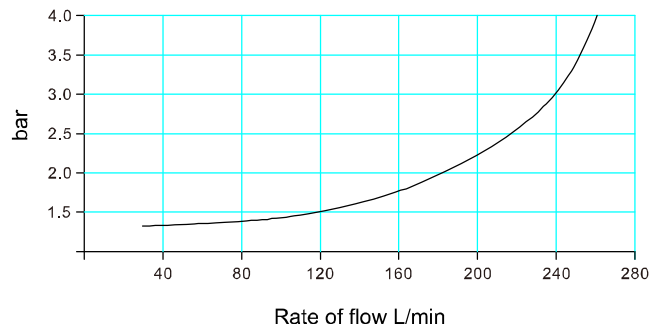
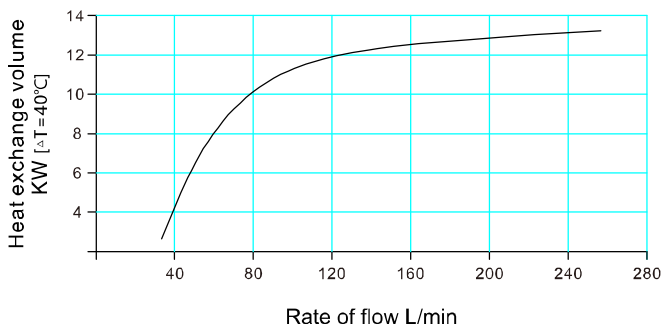

# LOC coolers by motor series

## Specifications

## LOC2-033-240L



Model	LOC2-033	Fan power	0.75KW/1.5KW/2.2KW
Rate of flow	240L/min	Weight	92KG
Working pressure	≤2MPa	Packing size	75*72*56CM
Exterior cooling area	11M <sup>2</sup>	Fan voltage	AC220V/AC380V/AC415V/AC440V/50HZ Special voltage & size can be customized
Cooling Capacity	18KW	Thermostat	Operational Temperature 50°C (Tolerance ±3°C)

## Dimensions

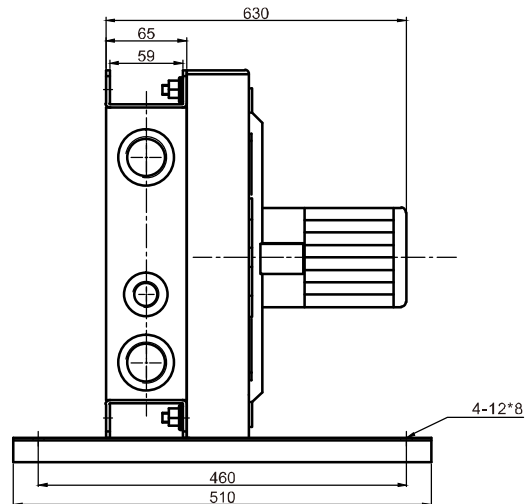
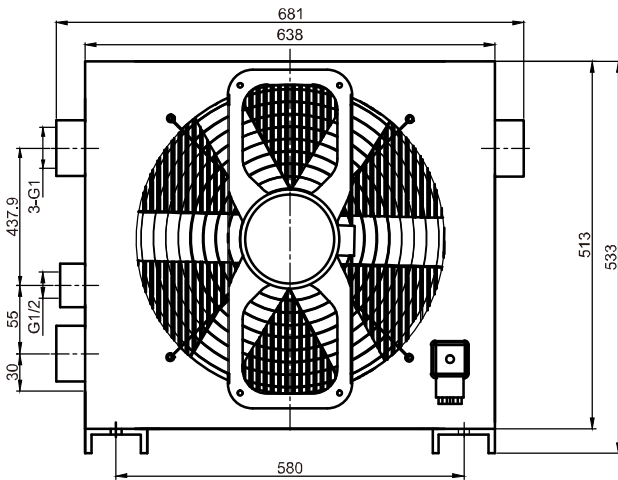

## Performance Curves

Heat diffusion function

Pressure graph

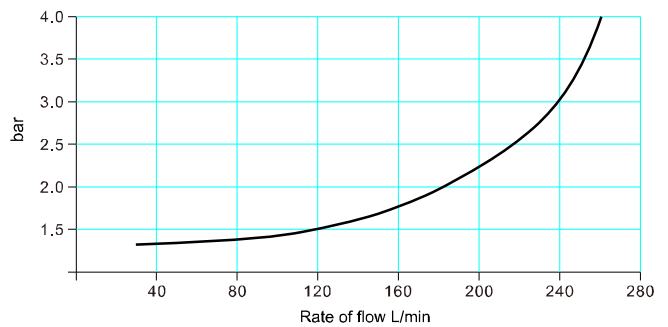
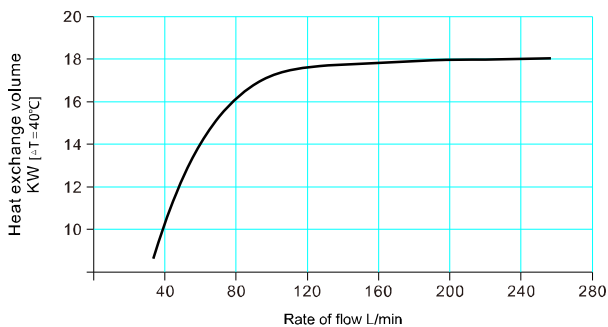

## AH coolers by motor series

### Specifications

### AH2431T-CA-B-450L

Model	AH2431T-CA-B	Cooling Capacity	34KW
Rate of flow	450L/min	Weight	92KG
Working pressure	≤2MPa	Packing size	75*72*56CM
Fan power	836W	Fan voltage	AC380V/50HZ
Exterior cooling area	33.2M <sup>2</sup>	Special voltage & size can be customized	

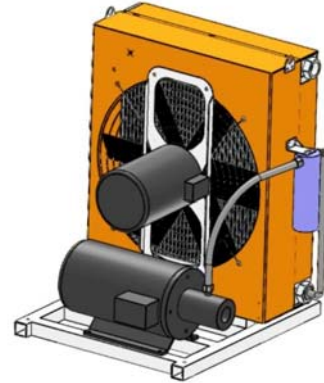

### Dimensions

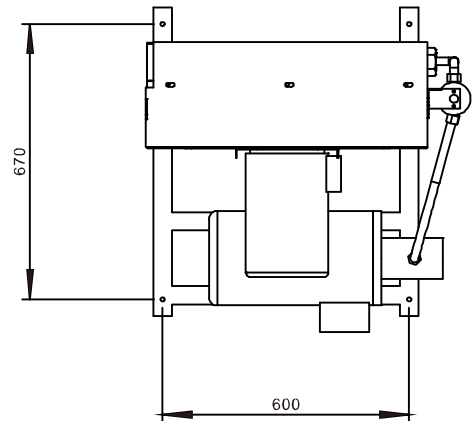
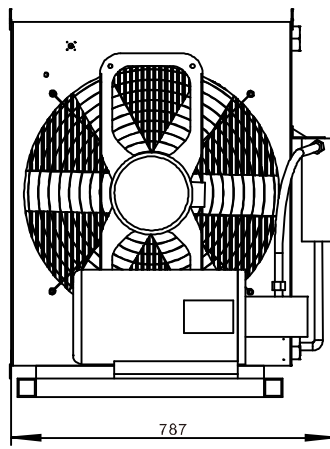
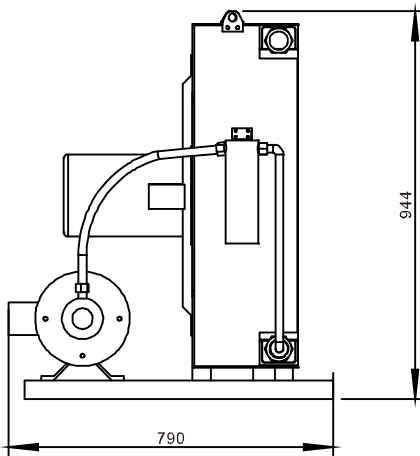

### Performance Curves

Heat diffusion function

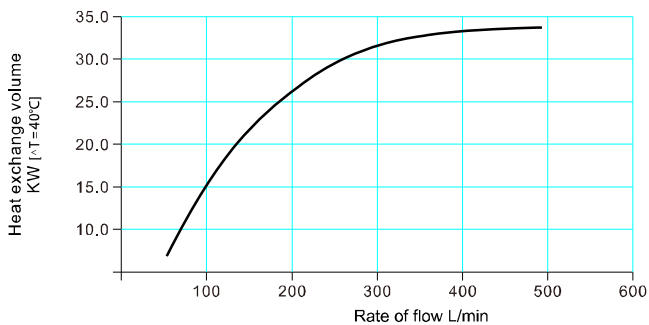

Pressure graph

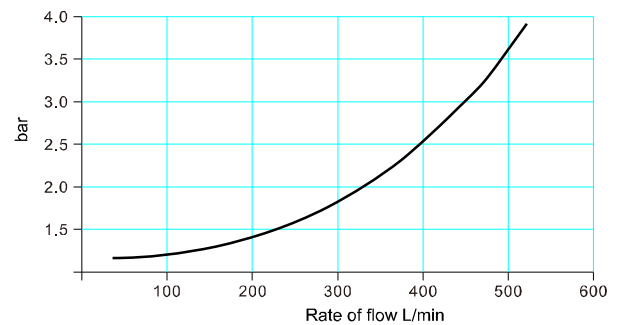

## AJ Series Oil coolers(the harmonica type)

### Specifications

### AJ0510T-CA-10L



Model	AJ0510T-CA	Cooling Capacity	1.2KW
Rate of flow	10L/min	Weight	2KG
Working pressure	≤3MPa	Packing size	27*23.5*15CM
Fan power	34W	Fan voltage	AC110V/AC220V-240V/AC380V/ DC12V/DC24V/50HZ
Exterior cooling area	0.9M <sup>2</sup>	Special voltage & size can be customized	

### Dimensions

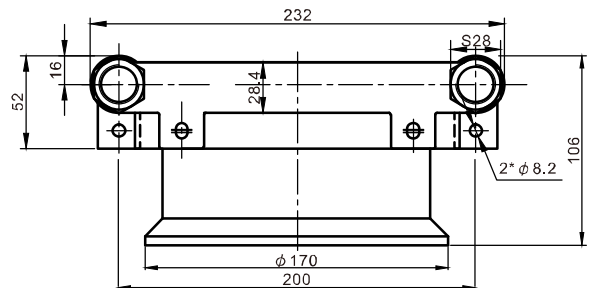
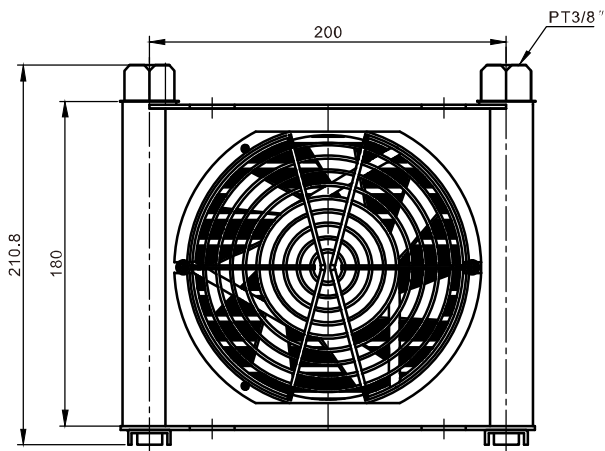

### Performance Curves

Heat diffusion function

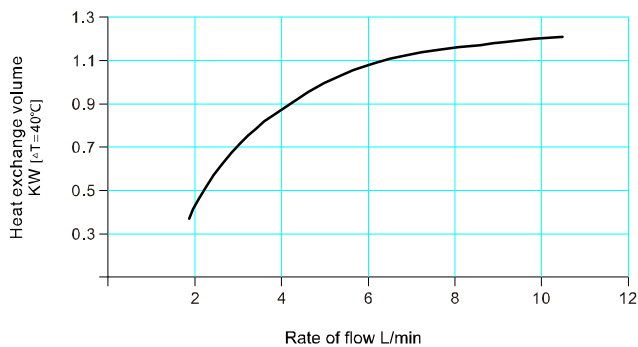

Pressure graph

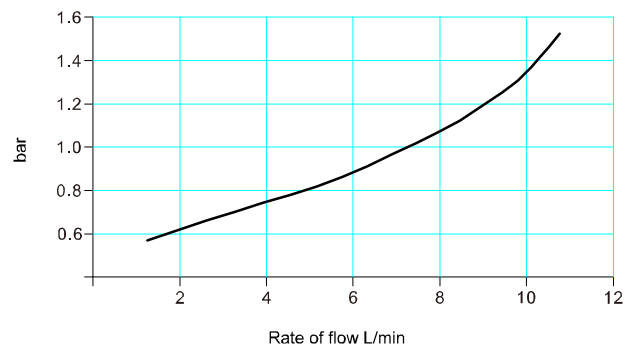

## AJ Series Oil coolers(the harmonica type)

### Specifications

AJ0608T-CA-60L

Model	AJ0608T-CA	Cooling Capacity	2.4KW
Rate of flow	60L/min	Weight	6KG
Working pressure	≤3MPa	Packing size	35*22.5*14CM
Fan power	34W	Fan voltage	AC110V/AC220V-240V/AC380V/ DC12V/DC24V/50HZ
Exterior cooling area	1.3M <sup>2</sup>	Special voltage & size can be customized	



### Dimensions

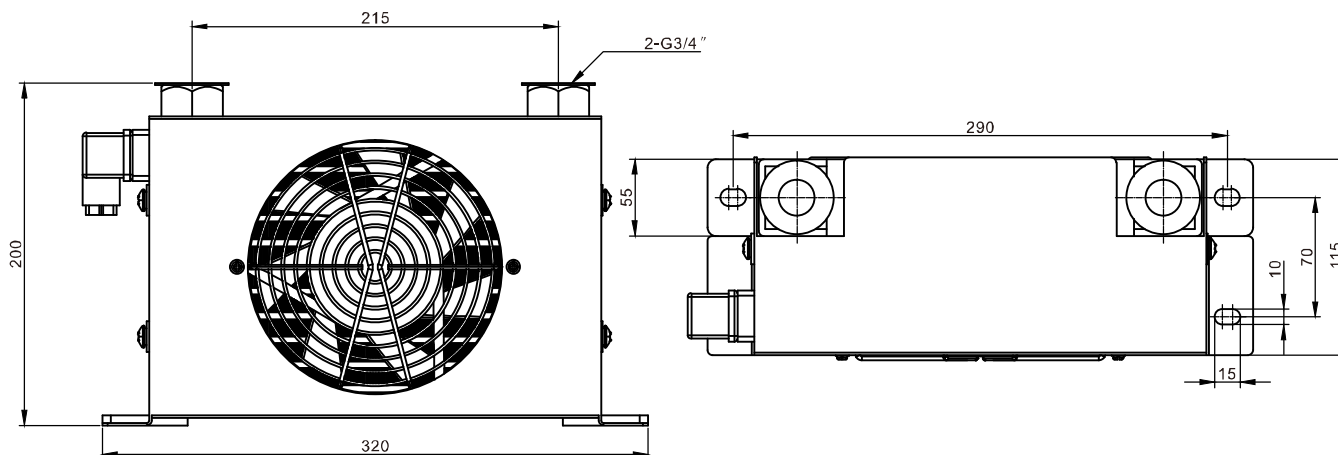

### Performance Curves

Heat diffusion function

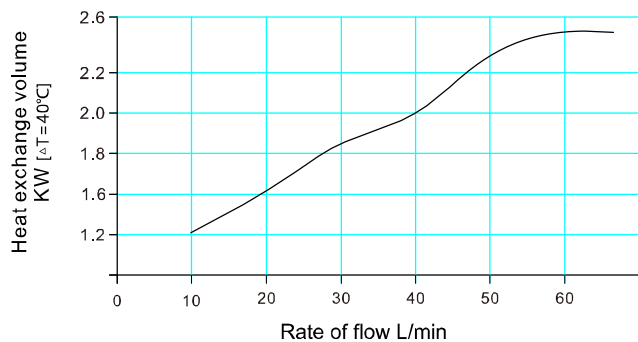

Pressure graph

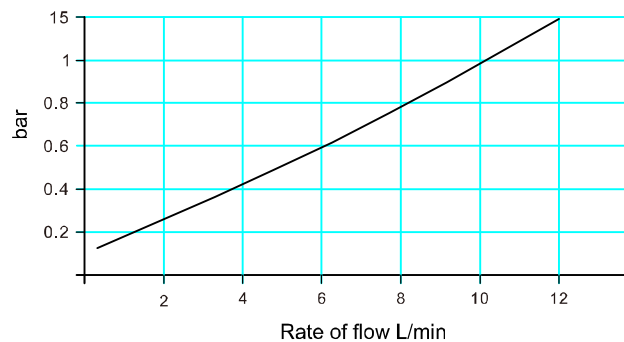

## AJ Series Oil coolers(the harmonica type)

### Specifications

**AJ1025T-CA-25L**

Model	AJ1025T-CA	Cooling Capacity	1.35KW
Rate of flow	25L/min	Weight	3KG
Working pressure	≤3MPa	Packing size	29*29*15CM
Fan power	34W	Fan voltage	AC110V/AC220V-240V/AC380V/ DC12V/DC24V/50HZ
Exterior cooling area	1.3M <sup>2</sup>	Special voltage & size can be customized	



### Dimensions

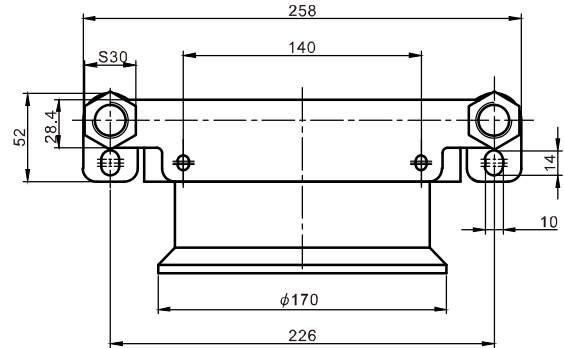
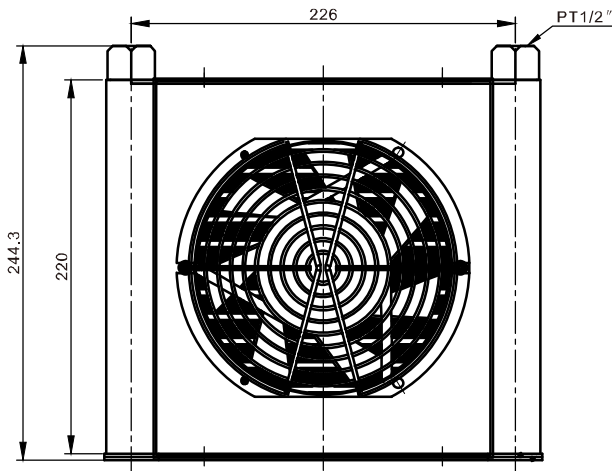

### Performance Curves

Heat diffusion function

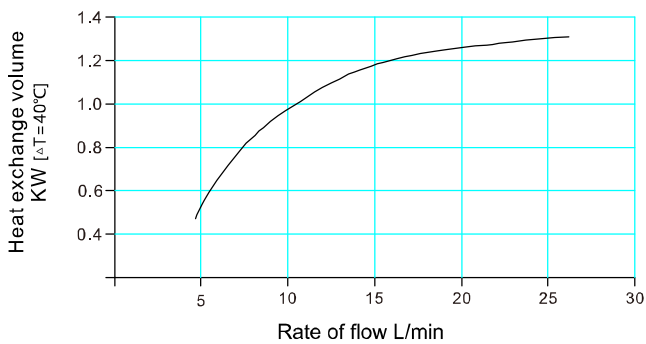

Pressure graph

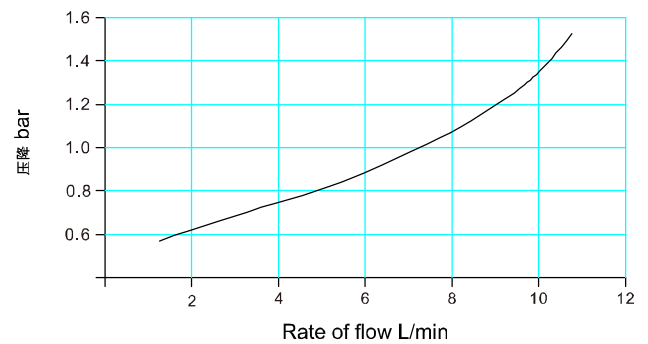

## AH series by pass valve oil cooler

### Specifications

### AH1012T1-CA-100L

Model	AH1012T1-CA	Cooling Capacity	5.8KW
Rate of flow	100L/min	Weight	12KG
Working pressure	≤2MPa	Packing size	44. 5*37*22CM
Fan power	45W/52W	Fan voltage	AC110V/AC220V-240V/DC12V/DC24V/50HZ Special voltage & size can be customized
Exterior cooling area	3.2M <sup>2</sup>	Thermostat	Operational Temperature 50°C (Tolerance±3°C)

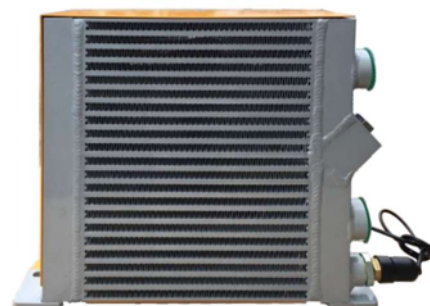

### Dimensions

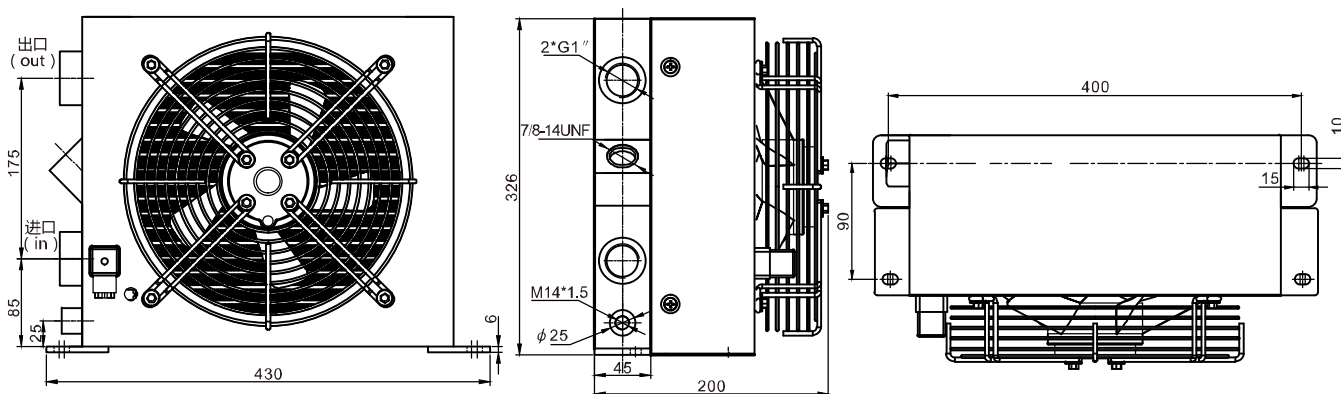

### Performance Curves

Heat diffusion function

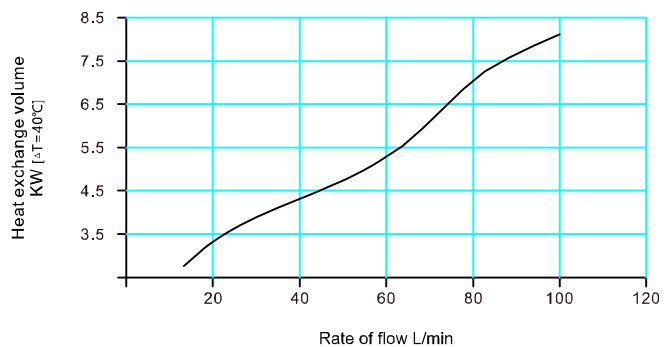

Pressure graph

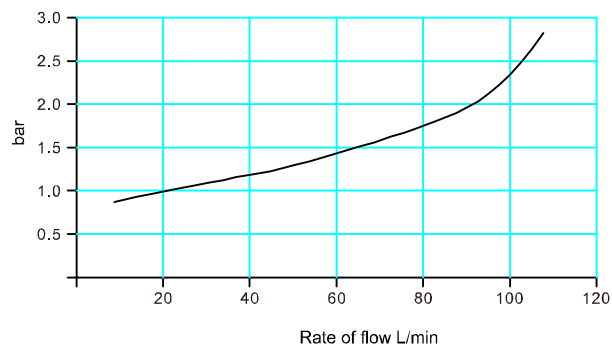

## AJ series by pass valve oil cooler

### Specifications

**AJ1012T1-CA-100L**

Model	AJ1012T1-CA	Cooling Capacity	3.6KW
Rate of flow	100L/min	Weight	12KG
Working pressure	≤3MPa	Packing size	44. 5*37*22CM
Fan power	45W/52W	Fan voltage	AC110V/AC220V-240V/DC12V/DC24V/50HZ Special voltage & size can be customized
Exterior cooling area	3.3M <sup>2</sup>	Thermostat	Operational Temperature 50°C (Tolerance ± 3°C)



### Dimensions

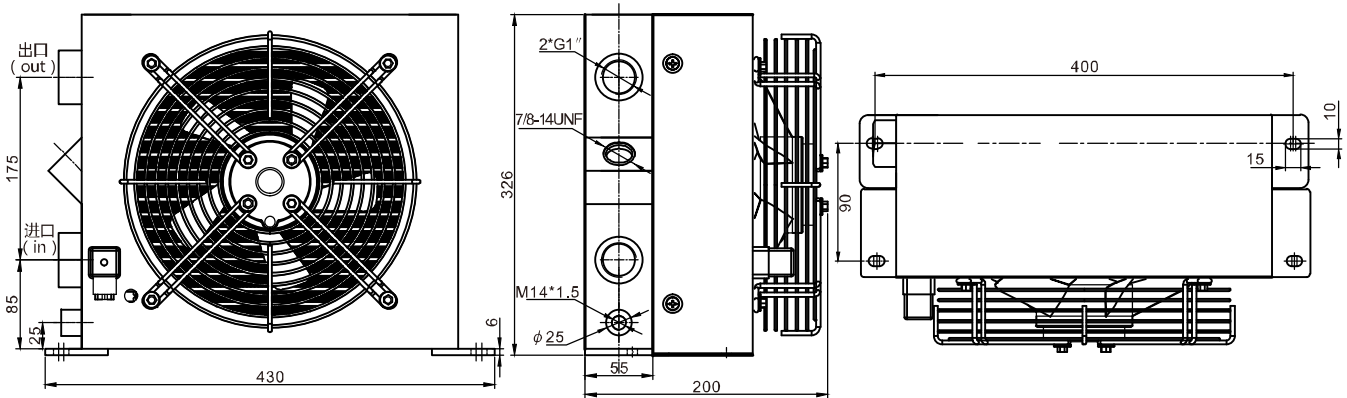

### Performance Curves

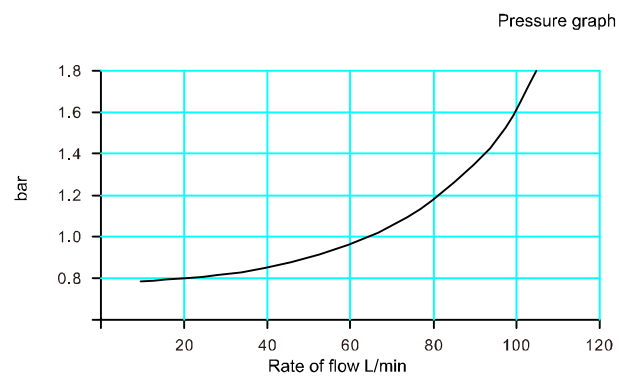
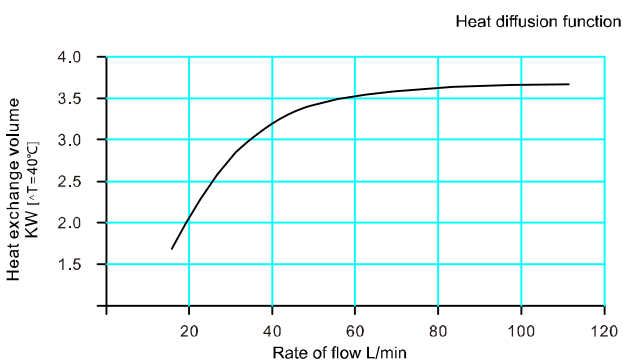



## RSOL series water coolers



### Characteristic

1. Screw-guide plate lead oil to flow in spiral type, in succession and well-distributed. It overcomes "the dead corner" of heat exchanging which is made by traditional deflector, so the efficiency of heat transfer is high, the loss of pressure is low.
2. The cooling tube is made of copper to roll fin outside. The product has a bigger heating surface but small size and light weight.
3. There are 2 or 4 channels in water side, but large quantity of flow (large lead of guide plate) and small quantity of flow (small lead of guide plate) in oil side. Various heat exchangers can meet customer's requirements.
4. Manufacture according to technology and production management style of JAPAN. The quality of RISEN heat exchanger is reliable and stable.

### Dimensions

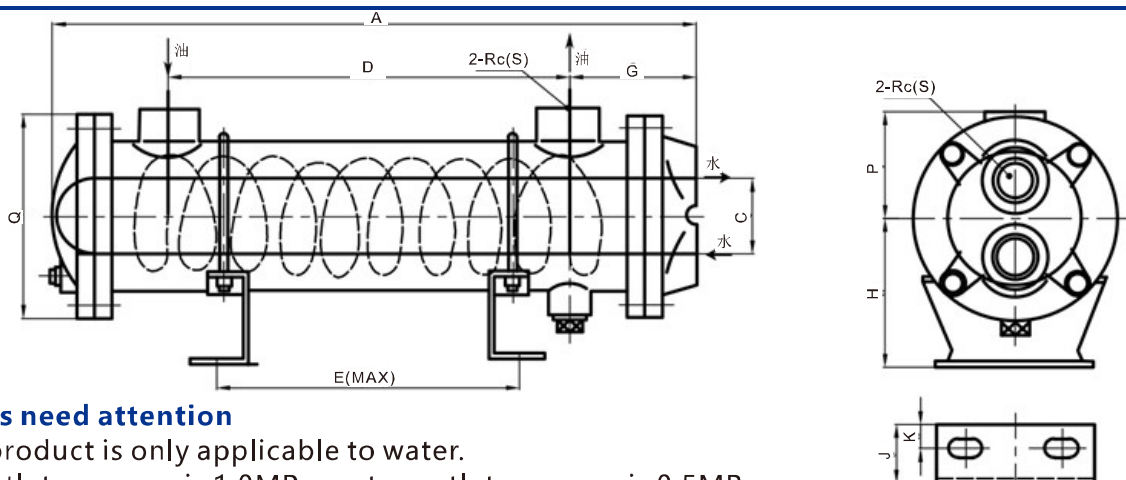

### Matters need attention

1. This product is only applicable to water.
2. Oil outlet pressure is 1.0MPa; water outlet pressure is 0.5MPa.
3. When the cooler is not in operation, the coolant water should be discharged in the seasons when the coolant water might be frozen.
4. Clean the inner side of the heat exchange pipe (water outlet) every six months to keep favorable cooling effects.

## RSOL series water coolers

### Selection Method

#### 1. Calculate the heat needed for exchange (Q=Kcal/hr)

(1) Base on the temperature requirement and flow of oil to calculate  $Q=Cp q(T1-T2)$

In the formula: C-specific heat of oil; p-density of oil; q-flow of oil; T1-inlet temperature of oil; T2-outlet temperature of oil

(2) Base on the heat produced in hydraulic system to calculate  $Q=Pr-Pc-Phc$

In the formula: Pr- input power for hydraulic system; Pc-effective output power; Phc-tank; pipe cooling power

#### 2. Selection of cooler model

Base on the calculated heat exchanged and flow performance curve, the cross-section of the curve in the right is the required model.

#### 3. Supplement

The actual condition might have difference with the testing performance. When the oil viscosity is small, water flow is large and the difference between the temperature of oil and water is large, a small size model should be chosen and vice versa.

TYPE	A	C	D	E	F	G	H	J	K	L	M	N	P	Q	R	S	T
RSOL-303	309	45	152	107	85	81	87	35	15	95	58	11	62	120	89	Rø3/4 φ28.5 (DN20)	Rc3/4
304	381		224	179													
305	453		296	251													
307	597		440	395													
309	741		584	539													
311	885		728	683													
313	1030		872	827													
315	1172		1015	970													
RSOL-408	469	60	284	240	110	95	125	50	20	160	110	18	87	150	114	Rø3/4 φ43 (DN32)	Rc3/4
411	613		428	384													
415	757		572	628													
418	901		716	672													
421	1045		860	816													
424	1188		1003	959													
428	1261		1076	1032													
RSOL-509	494	70	262	198	130	121	160	50	20	180	120	18	105	180	139	Rø11/2 φ52 (DN40)	Rc1
518	638		406	342													
526	854		622	558													
534	1070		838	774													
542	1288		1054	990													
549	1051		1269	1205													
554	1612		1380	1316													

### Performance Curves

Specifications and design characteristics may be change without prior notice.

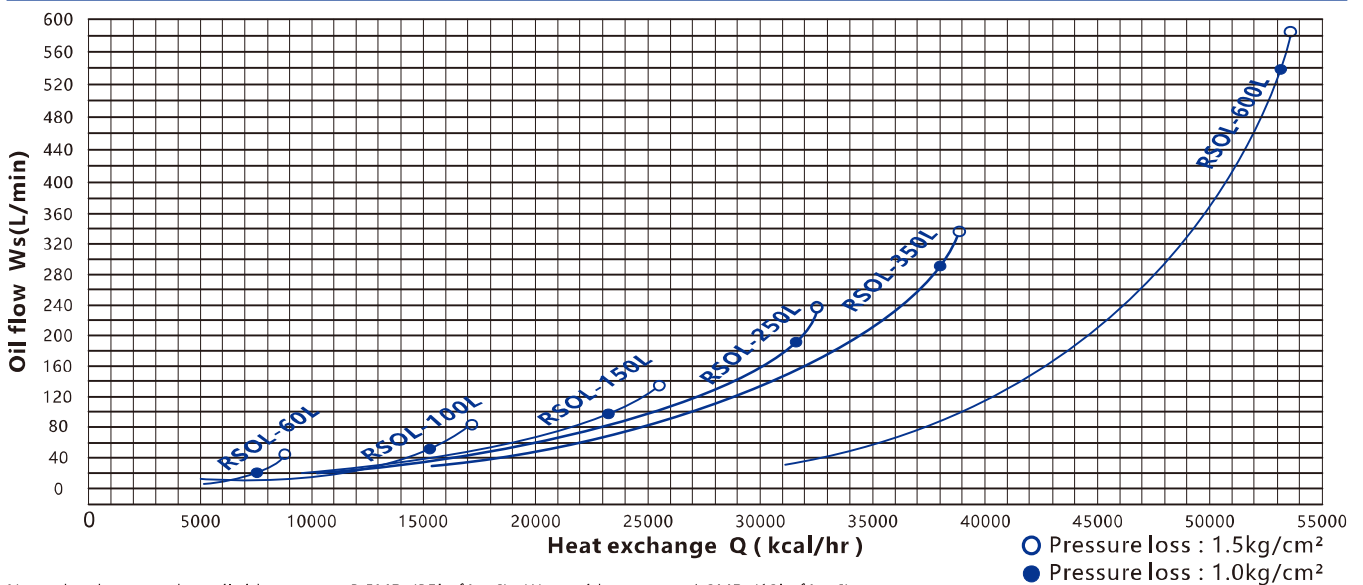

## RSGYF Series Wall-mounting Electrical Cabinet cooler



### Features:

1. The air in the plant is circulated when flowing through the core of oil cooler, reducing the temperature in the control cabinet using aluminum fin which makes the internal temperature of cabinets close to the outside temperature on the basis of heat transfer.
2. Enclosed design isolates interior and exterior air.
3. Energy efficiency and environmental protection, low-noise.
4. Avoid moisture condensation due to super-cooling.
5. Ultrathin and light design convenient for transportation and installation.
6. Facilitate maintenance and inspection.

### Scope of application:

1. CNC machinery;
2. Communication facility;
3. Control cabinet for heavy machinery; Measuring apparatus.

### Example:

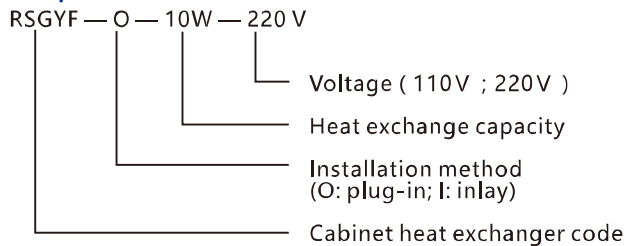

## RSALA Series Wall-mounting Electrical Cabinet cooler

### Technical parameters

Model	RSALA050A		RSALA10A		RSALA15A		RSALA25A		RSALA35A		RSALA50A	
Heat exchanger capacity	5		10		15		25		36		50	
Voltage	110	220	110	220	110	220	110	220	110	220	110	220
Power	20x2		20x2		30x2		30x2		30x2		30x4	
Current	0.48	0.24	0.48	0.24	0.48	0.24	0.48	0.24	0.48	0.24	2	0.96
Size(L*H*W)	212x450 124		212x450x148		250x780x80		295x780x90		295x860x120		414x940x120	
Reference Weight(kg)	6		7		8		10		12		18	

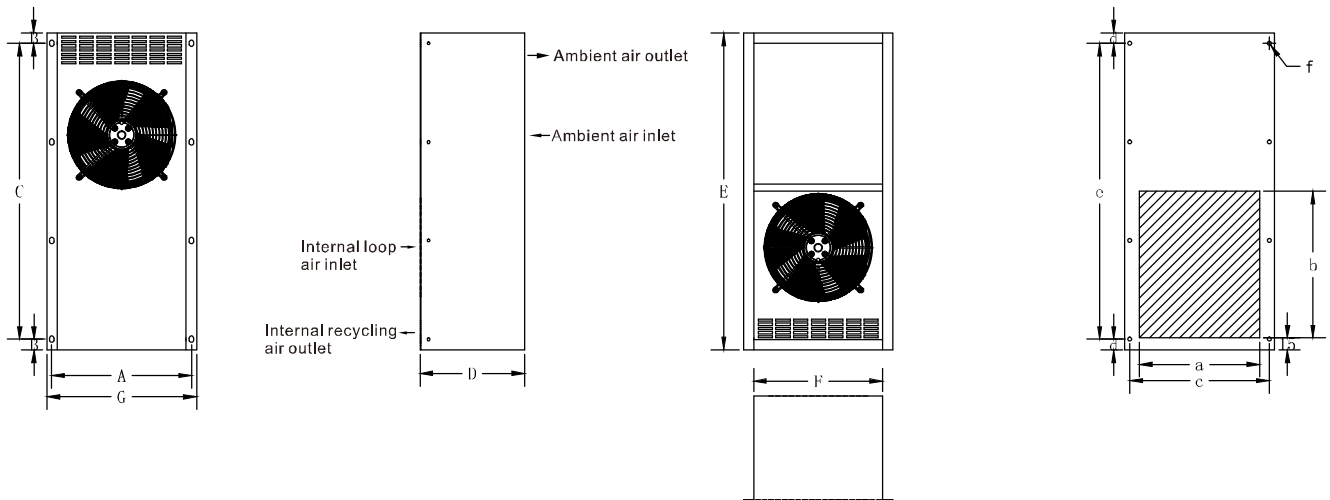

Dimensions 1:

TYPE	A	B	C	D	E	F	G
RSALA-05A	198	15	140x3=420	124	450	182	212
RSALA-10A	198	15	140x3=420	148	450	182	212
RSALA-15A	236	20	185x4=740	80	780	215	250
RSALA-25A	281	20	185x4=740	90	780	265	295
RSALA-35A	281	20	205x4=820	118	860	265	295

Dimensions 2:

TYPE	a	b	c	d	e	f
RSALA-05A	180	200	198	15	140x3=420	8- $\phi$ 5.5
RSALA-10A	180	200	198	15	140x3=420	8- $\phi$ 5.5
RSALA-15A	220	380	236	20	185x4=740	10- $\phi$ 5.5
RSALA-25A	260	380	281	20	185x4=740	10- $\phi$ 6.5
RSALA-35A	260	430	281	20	205x4=820	10- $\phi$ 6.5

## Cooler For Concrete Mixers

### Specifications

AHJ-20-CA

#### Circle Cask Type Concrete Mixer Oil coolers

Switching temp (°C)		Maximum Allowed temp (°C)		Oil Volume (L/min)	Heat Transfer@FTD40 (kw)	Oil Pressure Drop@30cSt (bar)
closing (°C) +3-2°C	opening (°C) +3-2°C	pemanent	short term	20	6.2	0.10
				50	6.6	0.35
				80	7.0	0.60
65	60	75	95	45	10.1	0.28
55	50	65	85	80	10.3	0.60

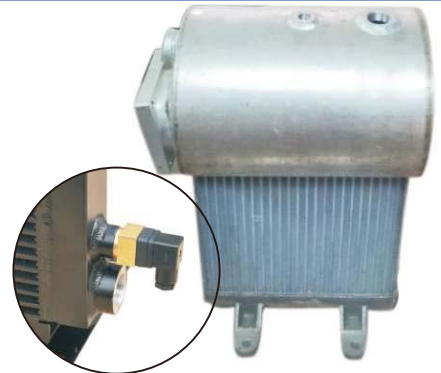

Thermostat

### Specifications

AHD-20-CA

#### Chamfering Type Concrete Mixers Oil Coolers

Oil cooler applied for concrete mixer		6 ~7m <sup>3</sup>	
Fan speed	2500rpm	Fan dia	280mm
Fan power	6~12KW	Fan motor voltage	12v/ 24v

### Dimensions

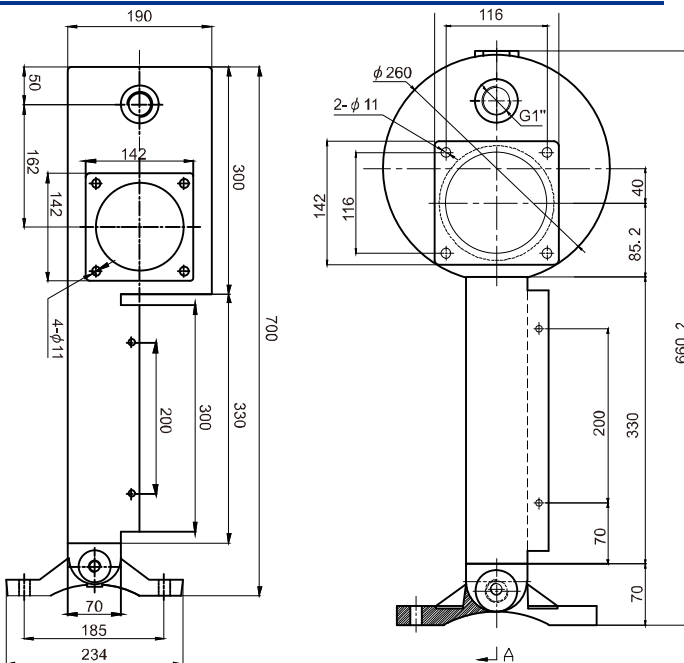

Radiator Oil Cooler OEM Service Provided



# Quality achievements in the future

Do the industry benchmarking enterprises, to create maximum value for customers



Customer  
**Trust**

Part of the cooperation of customers



# Products Application

The air cooler is widely used in hydraulic station, CNC machine tools, engineering machinery, wind power equipment, port machinery, plastic machinery, metallurgical machinery, shipbuilding industry and other fields, to provide solutions for the equipment of hydraulic and lubrication system to reduce the temperature of the fluid.



工程机械  
Construction machinery



搅拌车  
Mixer truck



弯管机  
Tube bending machine

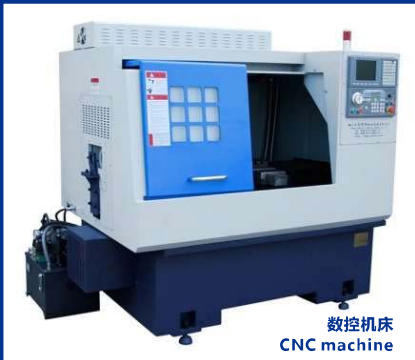

数控机床  
CNC machine



液压系统  
Hydraulic system



硫化机  
Vulcanizing machine



木工机械  
Wood working machinery



环保设备  
Environmental protection machine



风电设备  
Wind power equipment



特种车散热系统  
Special vehicle cooling system



包装机械  
Packing machinery



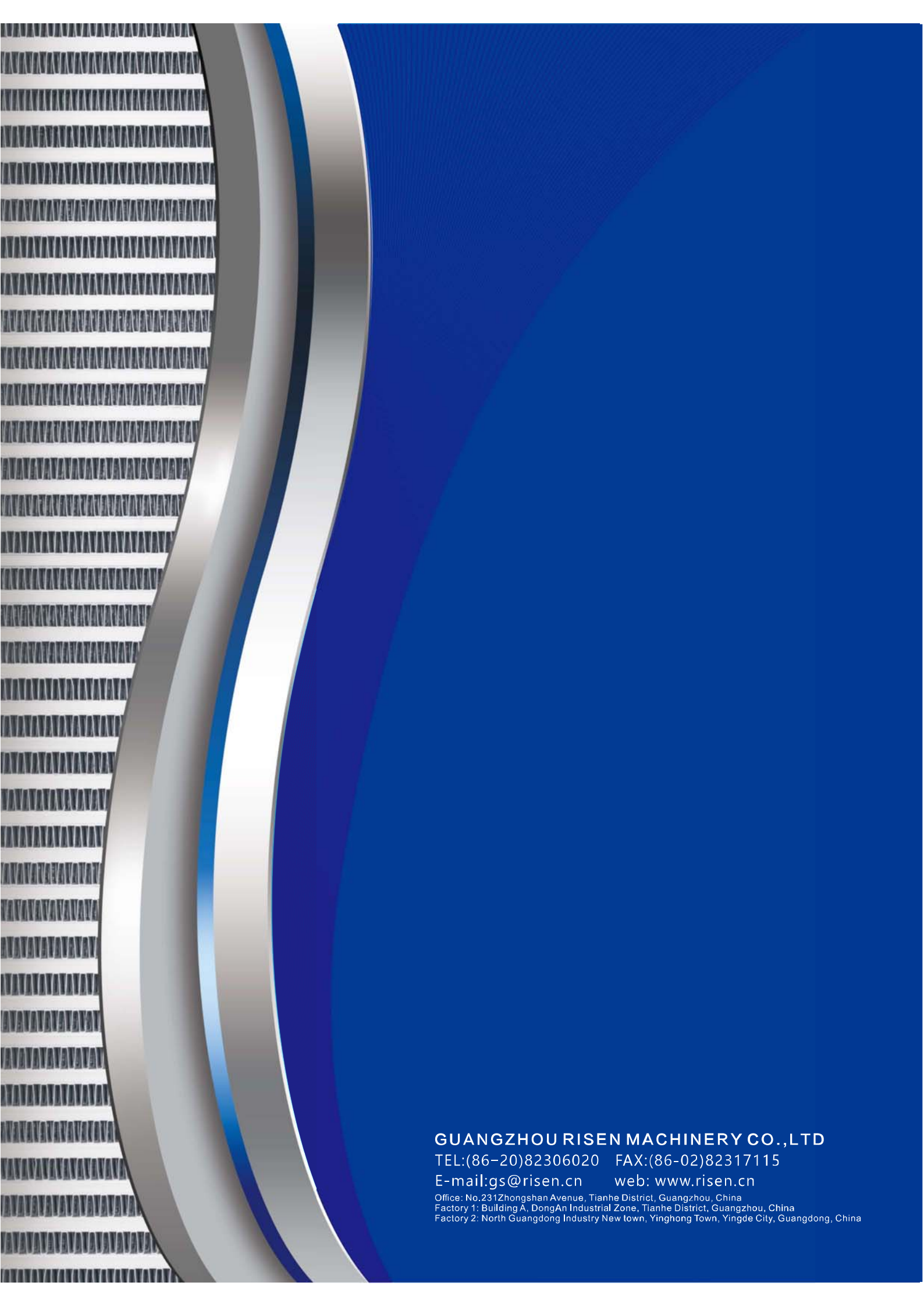

**GUANGZHOU RISEN MACHINERY CO.,LTD**

TEL:(86-20)82306020 FAX:(86-02)82317115

E-mail:gs@risen.cn web: www.risen.cn

Office: No.231Zhongshan Avenue, Tianhe District, Guangzhou, China

Factory 1: Building A, DongAn Industrial Zone, Tianhe District, Guangzhou, China

Factory 2: North Guangdong Industry New town, Yinghong Town, Yingde City, Guangdong, China